

Stylishly Contemporary

BRITTON[®]
BATHROOMS

The complete modern bathroom solution



Introduction

Britton — Form & Function.

Britton Bathrooms offers comprehensive, modular ranges of beautifully designed contemporary bathroom products. All of the ranges presented here were designed by international designer Tim Powell, arguably one of the most experienced bathroom product designers around. Tim’s intimate knowledge ensures both form and function is built into every product, with the very best in engineering and performance.



See page 02



See page 52



See page 60



See page 114



See page 151

Contents

CERAMICS

There are four beautiful ceramic ranges; Fine, Curve, Cube and Compact. All offer comprehensive ranges of models to suit your needs including the option of Tall height washbasins and WCs making your bathroom space more comfortable.

Pages 02-49



| | |
|-------------------|-------|
| Ceramics Overview | 02-07 |
| Fine | 08-19 |
| Cube | 20-29 |
| Curve | 30-41 |
| Compact | 42-49 |

TAPS & ACCESSORIES

The two brassware ranges, Crystal and Sapphire, offer every option from basin mixers through to bath shower mixers, ensuring a seamless look across your entire bathroom. The new thermostatic shower valves, paired with fantastic new shower heads, introduce safe and controllable showering for you and your family.

Pages 50-57



| | |
|------------------|-------|
| Taps | 50-53 |
| Baskets & Wastes | 54-55 |
| Accessories | 56-57 |

FURNITURE

The Britton Aqua-Cabinets furniture ranges are designed specifically for bathroom use. From free-standing options to fitted furniture, both available with seamless basin options and all packed with useful features, they provide a great storage space for today’s bathroom necessities.

Pages 58-99

| | |
|--------------------|-------|
| Furniture Overview | 58-63 |
| Compact | 64-66 |
| Gullwing & Arc | 67-71 |
| D45 | 72-76 |
| D30 Fitted | 77-87 |
| Mix & Match | 90-93 |
| Cloakrooms | 94-99 |

BATHS

The Britton Cleargreen baths bring superb design and a wide choice of size and model configurations to meet your needs. From standard baths, to specially shaped shower baths and even free-standing baths, each manufactured from 30% recycled material.

Pages 100-128



| | |
|---------------------|---------|
| Baths Overview | 100-101 |
| Freestanding Baths | 102-111 |
| Single Ended Baths | 112-113 |
| Double Ended Baths | 114-116 |
| Off-Set Baths | 117 |
| Bath Shower Screens | 120-121 |
| Showering Baths | 122-128 |

SHOWER TRAYS & VALVES

With the widest range of shapes and sizes available, combined with their rigid construction with metal re-inforcing, plus a low 35mm high step in, Zamori shower trays are the perfect choice for the modern bathroom.

Pages 129-136

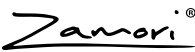

| | |
|------------------------|---------|
| Thermostatic Showering | 129 |
| Shower Tray Overview | 130-131 |
| Shower Trays | 132-136 |



Ceramics

Britton ceramic ranges include the exquisite Fine range with ultra sleek edges, Curve with sweeping corners, Cube with geometric and angular shapes and the Compact, a new range designed with short projection especially for bathrooms with limited space. Every basin design is interchangeable onto various pedestal options. From the sleek, round-fronted full or semi pedestal options, to the geometric square-fronted full or semi pedestal options, you can tailor make your own bathroom design to suit your individual tastes. Why not select our stunning and dramatic pedestal option in stainless steel, both as full or semi pedestal sizes, in a rounded style, for an eye-catching appearance? The Tall pedestal and Tall WC options make the bathroom a more comfortable environment for taller users and the elderly. All our stylish ranges include various basin, WC and bidet options for a consistently beautiful bathroom.



The Ceramic Range

Stunning Ceramic design to suit your individual tastes

Britton’s design of each core ceramic range is governed largely by the washbasin style. From Fine with its delicate rim, Curve with subtle sweeping edges, Cube with geometric angles or the new Compact range with generous depth and short projection.

Every basin is crafted to the highest quality using exceptional materials and manufacturing processes. Available in a range of sizes and completely modular with various pedestal options, also with the ability to pair with matching WCs and bidets, you can create a seamless and design linked bathroom.



FINE
The Fine range of basins, WCs and bidets are exquisitely crafted to form ultra slim edges to each of the ceramic pieces. These products are to be firm favourites, creating a unique designer feel to the contemporary bathroom space.
Pages 8-19



CURVE
Spacious with soft, subtle lines, the Curve range gives a simplistic aesthetic to the modern day bathroom for those who prefer sweeping edges and a minimal appearance.
Pages 32-43

CUBE
The Cube collection is a distinctive and stylishly designed range with geometric shapes and subtle angular edges, which work beautifully within a contemporary styled bathroom.
Pages 20-29



COMPACT
The gorgeous new compact range for Britton features stunning ceramic pieces designed with a shorter projection to maximise the use of space in your bathroom.
Pages 42-49



The Tall option

As Britton ceramics are designed to be completely modular, you have the option to pair the round fronted Tall pedestal design with any basin style. It has been designed to be completely modular across Fine, Cube, Curve and the new Compact ranges. Similarly, WC back-to-wall or close-coupled pans also feature as a Tall option. These have been designed specifically to ensure your bathroom is beautiful, functional and easy to use. Tall pedestals and WC pans are 6cm higher than the standard option making your bathroom easier for both taller people and the elderly. The pedestals help to reduce back pain when arching over to wash your hands whilst the WC pans help to keep knee angles at approximately 90 degrees providing more comfort in use. They also offer an easier solution to getting off the toilet for those less able.

CERAMICS



Tall Pedestal
Curve 60cm basin shown with a Tall pedestal

Standard Pedestal
Curve 60cm basin shown with a standard pedestal



CERAMICS



Tall Close Coupled WC
Curve Tall close coupled WC with cistern with lid with Carbamide soft-close seat

Standard Close Coupled WC
Curve close coupled WC with cistern with lid with Carbamide soft-close seat

Fine

nanoGLAZE
ceramic that stays cleaner

A cleaner toilet, by design and with NANO Glaze

We believe that the toilet bowl should still remain as clean as possible, even with reduced flushing water and we therefore engineer our toilet bowls to maintain the correct water area as previous British Standards and by coating the toilet bowl with NANO Glaze to make them exceptionally easy to keep clean.

Close-coupled back-to-wall WC with one piece cistern
Also available as back-to-wall or wall-hung options.



Back-to-wall bidet
Also available as wall-hung.



The Fine range of basins, WCs and bidets are exquisitely crafted to form ultra slim edges to each of the ceramic pieces. These products continue to be firm favourites, creating a unique designer feel to the contemporary bathroom space. A widely anticipated addition to the range is the new semi-recessed Fine basin, which can be elegantly set into counter-tops or as part of our Aqua-Cabinets furniture range.

50cm Washbasin
Available with full or semi pedestal options in square or round designs in ceramic or stainless steel.



BASIN OPTIONS ↓

The Fine washbasin is also available as a 60cm and can be wall-hung with a bottle trap or mounted on a work-top. A new Fine 55cm semi-recessed basin is also available.





The Fine basin features a beautifully and uniquely minimal edge, which looks superior when paired with a full pedestal in either a round or square fronted design. The height and stance works perfectly with close-coupled WCs, available with cisterns with lids, or as a single piece of ceramic. The back-to-wall options allow you to hide all the plumbing for the neatest look.

PEDESTAL OPTIONS ↓

All Fine basins can be mounted on Cube square full and semi pedestals, allowing the freedom to create the perfect look



This page: Fine back-to-wall bidet with Crystal bidet mixer, Fine back-to-wall WC with Carbamide soft-close seat with concealed cistern and flush plate and toilet roll holder. *Opposite:* Fine 60cm basin and square full pedestal with Crystal basin mixer and click-clack waste. Fine close-coupled back-to-wall WC with cistern with lid and Carbamide soft-close seat and soap dispenser.

See page 16 for technical details on the Fine basin and page 18 for technical details on the Fine WC range.

SEMI-RECESSED BASIN

Design a bathroom to suit your specific needs

A widely anticipated addition to the Fine range, a stunning semi-recessed basin with a 55cm width allows you to tailor your bathroom to suit your own individual tastes. Set into counter-tops, or pair with our stunning furniture range by Aqua-Cabinets.

See page 16 for technical details on the Fine basin.

CERAMICS



This page: Fine 55cm semi-recessed basin with Crystal basin mixer and click-clack waste.

Opposite page: Fine wall-hung WC with Carbamide soft-close seat, concealed cistern and flush plate, toilet roll holder and Fine wall-hung bidet with Crystal bidet mixer.

CERAMICS



This page: Fine 50cm basin with round fronted semi pedestal each with Crystal basin mixer each and click-clack waste each. *Opposite:* Fine 60cm basin and square full pedestal with Crystal basin mixer and click-clack waste. Fine wall-hung WC with Carbamide soft-close seat with concealed cistern and flush plate, toilet roll holder and Fine wall-hung bidet with Crystal bidet mixer.

See page 16 for technical details on the Fine basin.



COUNTER-TOP BASIN OPTION → *Design a bathroom to suit your specific needs*

View our full range of basins online at
www.brittonbathrooms.com

To make the most out of your beautiful bathroom, utilise the stunning Fine 50cm basin on a countertop as a vanity option. This creates the illusion of space with a floating appearance. Fine 50cm basin with Crystal basin mixer and click-clack waste.



Basins - Fine



FINE 50 & 60CM BASINS WITH SQUARE FRONTED PEDESTAL

| | |
|-------------------------|-------------|
| 50cm basin | 40.1974 |
| 60cm basin | 40.1973 |
| Square fronted Pedestal | (C) FP.1978 |

FINE 50 & 60CM BASINS WITH SEMI PEDESTALS

| | |
|------------------------------|-------------|
| 50cm basin | 40.1974 |
| 60cm basin | 40.1973 |
| Round fronted semi pedestal | (D) SP.1033 |
| Square fronted semi pedestal | (E) SP.1979 |

The 50cm and 60cm basins in this section can be used with either the round fronted or the square fronted semi pedestals

FINE 55CM SEMI-RECESSED BASIN

| | |
|--------------------------|-------------|
| 55cm semi-recessed basin | (F) 40.6610 |
|--------------------------|-------------|

The 55cm semi-recessed basin is 45cm deep



All our semi pedestals come complete with a fixing set



On all sanitaryware
See website for details

FINE 50 & 60CM BASINS WITH STANDARD AND TALL PEDESTALS

| | |
|-------------------|-------------|
| 50cm basin | 40.1974 |
| 60cm basin | 40.1973 |
| Tall Pedestal | (A) FP.1977 |
| Standard Pedestal | (B) FP.1032 |

The 50cm and 60cm basins on this page can be used with either the Standard or the Tall pedestal
The 50cm basin is 40cm deep; the 60cm basin is 45cm deep



WCs & Bidets - Fine

All Britton Cistern fittings are WRAS approved



FINE STANDARD HEIGHT WCs

| Type | Model | As Shown | Width | Depth | Overall Height | Pan Height | Pan Code | Cistern Code |
|------------------|--|----------|-------|-------|----------------|------------|----------|--------------|
| Close Coupled WC | With One-Piece cistern | (B) | 36cm | 65cm | 85cm | 42cm | 40.1968 | CC.1034 |
| Close Coupled WC | With Standard lid cistern | (F) | 36cm | 65cm | 85cm | 42cm | 40.1968 | CC.1036 |
| Back to wall WC | With concealed cistern tank with top/front access and dual flush button | (D) | 36cm | 52cm | 42cm | 42cm | 40.1971 | W31A |
| Wall Hung WC | With concealed cistern tank with top/front access and rectangular dual flush plate | (G) | 36cm | 52cm | variable | 36cm | 40.1969 | W32A |

** Concealed cistern must be ordered as a separate item to the WC pan.

Please note that both the flush plate & push button cistern can be used with the back to wall and wall hung WCs.

SEATS

| Colour | Material | Standard Seat | Soft Close Seat | Angled Soft Close Seat* |
|--------|-----------|---------------|-----------------|-------------------------|
| | | Code | Code | Code |
| White | Carbamide | PP.1943 | SS.1026 | SS.1027 |

* While stocks last

BIDETS

| Model | Ceramic | Width | As Shown | Depth | Bidet Height | Overall Height | Code |
|----------------|---------|-------|----------|-------|--------------|----------------|---------|
| Floor Standing | - | 36cm | (H) | 52cm | 42cm | 42cm | 40.1972 |
| Wall hung | - | 36cm | (I) | 52cm | 33cm | 42cm | 40.1970 |



All Britton WC fittings are factory set at 3L and 6L flush. They can be adjusted on site to flush at 2½L and 4½L.

FINE TALL HEIGHT WCs

| Model | Ceramic | As Shown | Width | Depth | Overall Height | Pan Height | Pan Code | Cistern Code |
|------------------|--|----------|-------|-------|----------------|------------|----------|--------------|
| Close Coupled WC | With One-Piece cistern | (A) | 36cm | 65cm | 91cm | 48cm | 48.1959 | CC.1034 |
| Close Coupled WC | With Standard lid cistern | | 36cm | 65cm | 91cm | 48cm | 48.1959 | CC.1036 |
| Back to wall WC | With concealed cistern tank with top/front access and dual flush button | (C) | 36cm | 52cm | 48cm | 48cm | 48.1963 | W31A |
| Back to wall WC | With concealed cistern tank with top/front access and rectangular dual flush plate | (C) | 36cm | 52cm | 48cm | 48cm | 48.1963 | W32A |

* Fine Tall WCs use Curve Tall pans.

** Concealed cistern must be ordered as a separate item to the WC pan.

Please note that both the flush plate & push button cistern can be used with the back to wall and wall hung WCs.



On all sanitaryware
See website for details



For detailed dimensions see www.brittonbathrooms.com/finewcs

Cube

A conventional and eye-catching close-coupled range of Cube styled products suits any contemporary bathroom. All Cube basins can also be paired with round fronted full and semi pedestals to suit your own individual tastes.

Cube 50cm basin with square full ceramic pedestal and Crystal basin mixer without waste and click-clack basin waste.
See page 26 for technical details on the Cube basin.

nanoGLAZE
ceramic that stays cleaner

A cleaner toilet, by design and with NANO Glaze

We believe that the toilet bowl should still remain as clean as possible, even with reduced flushing water and we therefore engineer our toilet bowls to maintain the correct water area as previous British Standards and by coating the toilet bowl with NANO Glaze to make them exceptionally easy to keep clean.

Close-coupled back-to-wall WC
Also available as back-to-wall or wall-hung options.



Back-to-wall bidet
Also available as wall-hung.



The Cube collection is a distinctive and stylishly designed range with geometric shapes and subtle angular edges, which work beautifully within a contemporary styled bathroom. Basins available with either full or semi pedestal options in both square and round styles or pair with a stainless steel option for an ultra modern and sleek look. Choose matching WCs and bidets to complete the look.

50cm washbasin
Available with full or semi pedestal options in square or round designs in ceramic or stainless steel.



BASIN OPTIONS ↓

The Cube washbasin is also available as a 60cm option or a 55cm semi-recessed for use within our stylish furniture pieces by Aqua-Cabinets or as a counter-top basin





Cube 50cm basins with round semi pedestal each, Crystal basin mixers without pop-up waste each and click-clack basin waste each. 60cm white mirrored double door cabinets each and 170cm x 70cm Sustain bath.

See page 26 for technical details on the Cube basin.



A perfect solution for modern bathrooms with limited space. The Britton Cube wall-hung range gives a seamless and unified look throughout your bathroom, whilst creating uninterrupted clean lines between walls and floors.

PEDESTAL OPTIONS ↓

All Cube basins can be mounted on Curve round full and semi pedestals, allowing the freedom to create the perfect look



Cube wall-hung bidet with Crystal bidet mixer with pop-up waste and Cube wall-hung WC with Carbamide soft-close seat and concealed cistern with flush plate. Cube 50cm basin with round semi-predestal, Crystal basin mixer and click-clack basin waste.



Cube back-to-wall bidet with Crystal bidet mixer with pop-up waste. Cube back-to-wall WC with Carbamide soft-close seat and concealed cistern with flush plate. Cube 55cm semi-recessed basin with Crystal basin mixer without pop-up waste, Cube 60cm white semi-recessed basin unit, 30cm white drawer unit, and 90cm white worktop. 60cm white mirrored double door cabinet, 30cm white double shelf unit and stainless steel round towel ring.

See page 28 for technical details on the Cube WC and Bidet range.

This back-to-wall range provides a clean attractive look to your contemporary bathroom. Pair Cube sanitaryware with white fitted furniture for a crisp, clean bathroom with functional storage space. See p60 for more details on fitted furniture.

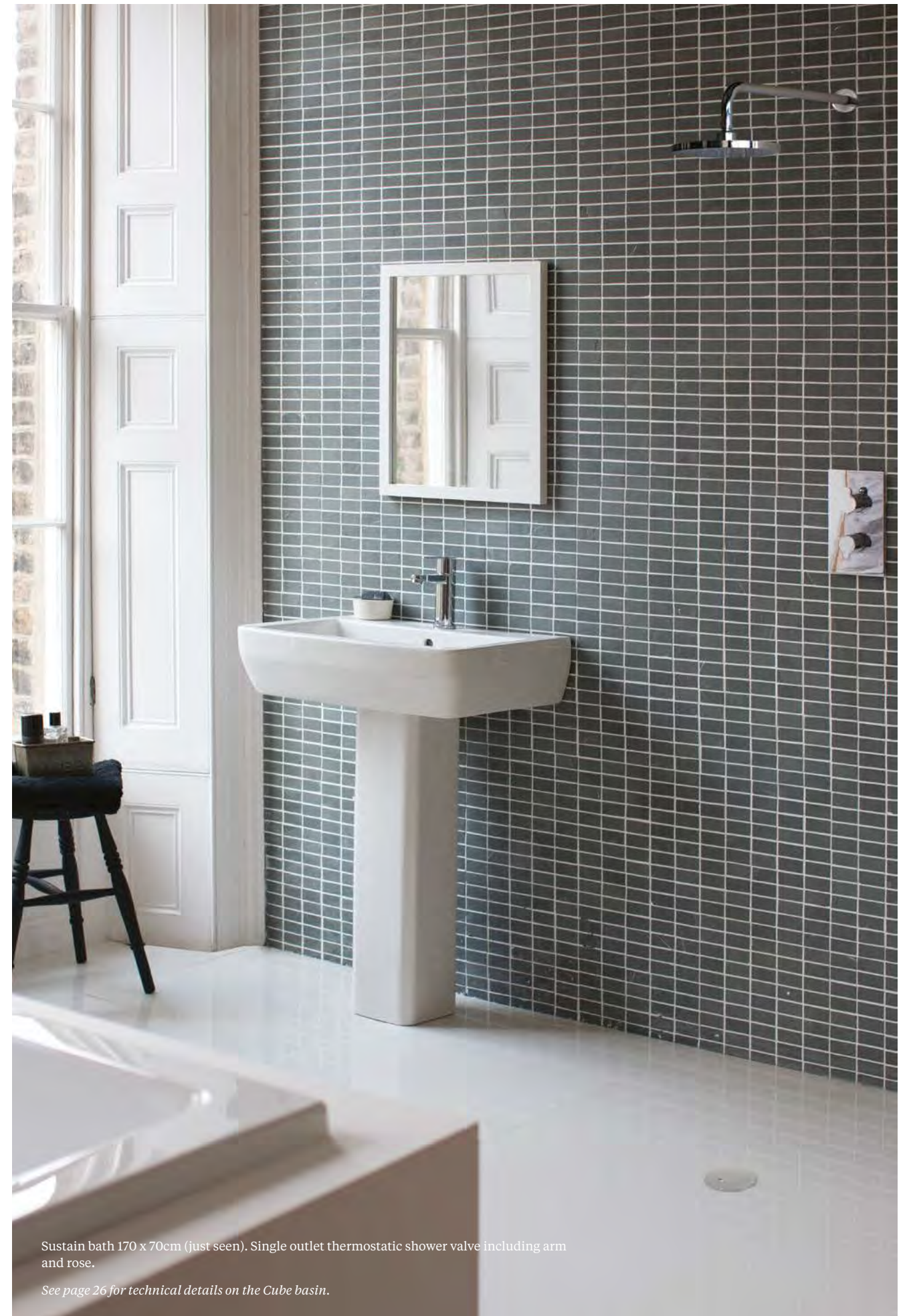

Sustain bath 170 x 70cm (just seen). Single outlet thermostatic shower valve including arm and rose.

See page 26 for technical details on the Cube basin.

Basins - Cube



CUBE 50 & 60CM BASINS WITH SQUARE FRONTED PEDESTAL

| | | |
|-------------------------|-----|---------|
| 50cm basin | | 20.1956 |
| 60cm basin | | 20.1955 |
| Square fronted Pedestal | (C) | FP.1978 |
| Towel rail | | TR.1026 |

CUBE 50 & 60CM BASINS WITH SEMI PEDESTALS

| | | |
|------------------------------|-----|---------|
| 50cm basin | | 20.1956 |
| 60cm basin | | 20.1955 |
| Round fronted semi pedestal | (D) | SP.1033 |
| Square fronted semi pedestal | (E) | SP.1979 |

The 50cm and 60cm basins in this section can be used with either the round fronted or the square fronted semi pedestals

CUBE 55CM SEMI-RECESSED BASIN

| | | |
|--------------------------|-----|---------|
| 55cm semi-recessed basin | (F) | 20.1954 |
|--------------------------|-----|---------|

The 55cm semi-recessed basin is 45cm deep



All our semi pedestals come complete with a fixing set



On all sanitaryware
See website for details

CUBE 50 & 60CM BASINS WITH STANDARD AND TALL PEDESTALS

| | | |
|-------------------|-----|---------|
| 50cm basin | | 20.1956 |
| 60cm basin | | 20.1955 |
| TALL Pedestal | (A) | FP.1977 |
| STANDARD Pedestal | (B) | FP.1032 |

The 50cm and 60cm basins on this page can be used with either the Standard or the Tall pedestal
The 50cm basin is 40cm deep; the 60cm basin is 45cm deep



WCs & Bidets - Cube

All Britton WC fittings are factory set at 3L and 6L flush. They can be adjusted on site to flush at 2½L and 4½L.



All Britton Cistern fittings are WRAS approved



CUBE STANDARD HEIGHT WCs

| Type | Model | As Shown | Width | Depth | Overall Height | Pan Height | Pan Code | Cistern Code |
|------------------|--|----------|-------|-------|----------------|------------|----------|--------------|
| Close Coupled WC | With One-Piece cistern | (A) | 36cm | 65cm | 85cm | 42cm | 20.1949 | CC.1034 |
| Close Coupled WC | With Standard lid cistern | (C) | 36cm | 65cm | 85cm | 42cm | 20.1949 | CC.1036 |
| Back to wall WC | With concealed cistern tank with top/front access and dual flush button | (D) | 36cm | 52cm | - | 42cm | 20.1952 | W31A |
| Wall Hung WC | With concealed cistern tank with top/front access and rectangular dual flush plate | (E) | 36cm | 52cm | 42cm | 33cm | 20.1950 | W32A |

** Concealed cistern must be ordered as a separate item to the WC pan.

Please note that both the flush plate & push button cistern can be used with the back to wall and wall hung WCs.



SEATS

| Colour | Material | Standard Seat | Soft Close Seat | Angled Soft Close Seat |
|--------|-----------|---------------|-----------------|------------------------|
| | | Code | Code | Code |
| White | Carbamide | - | SS.1025 | - |

BIDETS

| Model | Ceramic | Width | As Shown | Depth | Bidet Height | Overall Height | Code |
|----------------|---------|-------|----------|-------|--------------|----------------|---------|
| Floor Standing | - | 36cm | (F) | 52cm | 42cm | 42cm | 20.1953 |
| Wall hung | - | 36cm | | 52cm | 33cm | 42cm | 20.1951 |



On all sanitaryware
See website for details

Curve

Spacious with soft, subtle lines, the Curve range gives a simplistic aesthetic to the modern day bathroom for those who prefer sweeping edges and a minimal appearance.

nanoGLAZE ceramic that stays cleaner

A cleaner toilet, by design and with NANO Glaze

We believe that the toilet bowl should still remain as clean as possible, even with reduced flushing water and we therefore engineer our toilet bowls to maintain the correct water area as previous British Standards and by coating the toilet bowl with NANO Glaze to make them exceptionally easy to keep clean.

Close-coupled back-to-wall WC
Also available as open-back, back-to-wall or wall-hung options.



Back-to-wall bidet
Also available as wall-hung.



50cm Washbasin
Available with full or semi pedestal options in square or round designs in ceramic or stainless steel.



BASIN OPTIONS ↓

The Curve washbasin is also available as a 60cm option, or a 55cm semi-recessed for use within our stylish furniture pieces by Aqua-Cabinets, or as a countertop basin.





This close-coupled set is both minimal and stylish, offering you simple installation. The subtle lines create a beautiful aesthetic but also provide great functionality with deep basins giving ample room to wash your hands.

Curve 60cm basin with Crystal basin mixer without pop-up waste and click-clack waste.
See page 38 for technical details on the Curve basin and page 40 for technical details on the Curve WC range.



Curve back to wall bidet with Crystal bidet mixer.
Curve back-to-wall WC with carbamide angled soft-close seat.



The all in one curve basin is a striking piece for those wanting to make an impact in a modern bathroom. Pair with a Curve back to wall WC and Britton accessories to ensure this basin is the centrepiece of the bathroom.



Curve free-standing basin including white ceramic waste with Saphire basin mixer without waste.

See page 38 for technical details on the Curve basin.



Our beautiful Curve basin in either 50cm or 60cm sizes work as vanity work-top basins, maximising space and providing useful work surfaces.

PEDESTAL OPTIONS ↓

All Curve basins can be mounted on Cube round full and semi pedestals, allowing the freedom to create the perfect look



Curve 60cm basin, Saphire basin mixer without pop-up waste and click-clack basin waste.

See page 38 for technical details on the Curve basin.

Back-to-wall options continue to be a popular choice with those wishing to create an illusion of space within smaller bathrooms. Pair with wall-hung basins, basins set into fitted furniture or counter-tops to create functional storage options.



THE FINISHING TOUCH →
Sleek, modern Britton accessories

View our accessories on pages 56-57

Britton offers a selection of sleek accessories, which help transform your bathroom into a place of both form and function.



Opposite page: Curve back-to-wall bidet with Crystal bidet mixer, Curve back-to-wall WC with Carbamide angled soft-close seat.

This page and opposite: Curve 50cm basin with round semi-pedestal with Crystal basin mixer and click-clack basin waste.

See page 38 for technical details on the Curve basin

Basins & Pedestals - Curve



CURVE 50 & 60CM BASINS WITH SQUARE FRONTED PEDESTAL

| | |
|-------------------------|-------------|
| 50cm basin | 30.1967 |
| 60cm basin | 30.1966 |
| Square fronted Pedestal | (C) FP.1978 |

CURVE FREESTANDING BASIN

| | |
|---------------------------|-------------|
| 58.3cm freestanding basin | (D) 30.1968 |
|---------------------------|-------------|

The freestanding basin is 42cm deep, 86cm tall and includes a click-clack waste

CURVE 50 & 60CM BASINS WITH SEMI PEDESTALS

| | |
|------------------------------|-------------|
| 50cm basin | 30.1967 |
| 60cm basin | 30.1966 |
| Round fronted semi pedestal | (E) SP.1033 |
| Square fronted semi pedestal | (F) SP.1979 |

The 50cm and 60cm basins in this section can be used with either the round fronted or the square fronted semi pedestals

CURVE 55CM SEMI-RECESSED BASIN

| | |
|--------------------------|-------------|
| 55cm semi-recessed basin | (G) 30.1965 |
|--------------------------|-------------|

The 55cm semi-recessed basin is 45cm deep



All our semi pedestals come complete with a fixing set



On all sanitaryware
See website for details

CURVE 50 & 60CM BASINS WITH STANDARD AND TALL PEDESTALS

| | |
|-------------------|-------------|
| 50cm basin | 30.1967 |
| 60cm basin | 30.1966 |
| TALL Pedestal | (A) FP.1977 |
| STANDARD Pedestal | (B) FP.1032 |

The 50cm and 60cm basins on this page can be used with either the Standard or the Tall pedestal
The 50cm basin is 40cm deep; the 60cm basin is 45cm deep



WCs & Bidets - Curve

All Britton Cistern fittings are WRAS approved



CURVE STANDARD HEIGHT WCs

| Type | Model | As Shown | Width | Depth | Overall Height | Pan Height | Pan Code | Cistern Code |
|---------------------------------|--|----------|-------|-------|----------------|------------|----------|--------------|
| Close Coupled (back to wall) WC | With One-Piece cistern | (A) | 36cm | 65cm | 85cm | 42cm | 30.1957 | CC.1034 |
| Close Coupled (open back) WC | With One-Piece cistern | | 36cm | 65cm | 85cm | 42cm | 30.1958 | CC.1034 |
| Close Coupled (back to wall) WC | With Standard lid cistern | (B) | 36cm | 65cm | 85cm | 42cm | 30.1957 | CC.1036 |
| Close Coupled (open back) WC | With Standard lid cistern | (C) | 36cm | 65cm | 85cm | 42cm | 30.1958 | CC.1036 |
| Back to wall WC | With concealed cistern tank with top/front access and dual flush button | (D) | 36cm | 52cm | 42cm | 42cm | 30.1962 | W31A |
| Wall Hung WC | With concealed cistern tank with top/front access and rectangular dual flush plate | (E) | 36cm | 52cm | 42cm | 33cm | 30.1960 | W32A |

** Concealed cistern must be ordered as a seperate item to the WC pan.

Please note that both the flush plate & push button cistern can be used with the back to wall and wall hung WCs.



SEATS

| Colour | Material | Standard Seat | Soft Close Seat | Angled Soft Close Seat |
|--------|-----------|---------------|-----------------|------------------------|
| | | Code | Code | Code |
| White | Carbamide | PP.1943 | SS.1026 | SS.1027 |

BIDETS

| Model | Ceramic | Width | As Shown | Depth | Bidet Height | Overall Height | Code |
|----------------|---------|-------|----------|-------|--------------|----------------|---------|
| Floor Standing | - | 36cm | (F) | 52cm | 42cm | 42cm | 30.1964 |



All Britton WC fittings are factory set at 3L and 6L flush. They can be adjusted on site to flush at 2½L and 4½L.

CURVE TALL HEIGHT WCs

| Type | Model | As Shown | Width | Depth | Overall Height | Pan Height | Pan Code | Cistern Code |
|------------------|--|----------|-------|-------|----------------|------------|----------|--------------|
| Close Coupled WC | With One-Piece cistern | (I) | 36cm | 65cm | 91cm | 48cm | 48.1959 | CC.1034 |
| Close Coupled WC | With Standard lid cistern | | 36cm | 65cm | 91cm | 48cm | 48.1959 | CC.1036 |
| Back to wall WC | With concealed cistern tank with top/front access and dual flush button | (J) | 36cm | 52cm | 48cm | 48cm | 48.1963 | W31A |
| Back to wall WC | With concealed cistern tank with top/front access and rectangular dual flush plate | (J) | 36cm | 52cm | 48cm | 48cm | 48.1963 | W32A |

* Complete WC price is for a complete WC as described. Price excludes seat. Fine Tall WCs use Curve Tall pans.
** Concealed cistern must be ordered as a seperate item to the WC pan. Price excludes seat.

Please note that both the flush plate & push button cistern can be used with the back to wall and wall hung WCs.



On all sanitaryware
See website for details



Compact

COMPACT

nanoGLAZE
ceramic that stays cleaner

A cleaner toilet, by design and with NANO Glaze

We believe that the toilet bowl should still remain as clean as possible, even with reduced flushing water and we therefore engineer our toilet bowls to maintain the correct water area as previous British Standards and by coating the toilet bowl with NANO Glaze to make them exceptionally easy to keep clean. This is of great benefit for WC pans with a shorter projection such as the Compact range, where the angle of the ceramic is steeper. NANO Glaze aids a cleaner toilet bowl.

The gorgeous new compact range for Britton features stunning ceramic pieces designed with a shorter projection of 40cm to maximise the use of space in your bathroom. Available in 45cm, 55cm and 65cm widths.

55cm washbasin
Available with both full or semi pedestal options.



Close-coupled WC
Also available as wall-hung or back-to-wall options.



BASIN OPTIONS ↓

The Compact washbasin is also available as a 45cm option to suit smaller bathrooms.





This page: Compact 45cm basin with round semi pedestal, Crystal basin mixer and click-clack basin waste. Compact wall-hung WC with Compact Carbamide soft-close seat. *Opposite:* Compact 65cm basin with round pedestal, Crystal basin mixer and click-clack basin waste. Ceramic soap dispenser. Compact back-to-wall WC with Compact Carbamide soft-close seat, toilet roll holder. Compact 45cm basin with round semi pedestal, Crystal basin mixer and click-clack basin waste.

See page 49 for technical details on the Compact basin and page 48 for technical details on the Compact WC range.





The close-coupled option in this new Compact range offers a stylish and ultra-modern solution to bathroom requirements where space is limited. To maximise space in your bathroom, choose a combination showering bath from the Cleargreen range which also are available in smaller sizes, at just 150cm.

This page and opposite: Compact 55cm basin with round full pedestal, Crystal basin mixer without pop-up waste and click-clack basin waste. Compact close-coupled WC with cistern and lid and Compact Carbamide soft-close seat, stainless steel toilet roll holder. Ecoround 150cm left-handed bath with front panel and end panel, click-clack bath waste, bath screen and Crystal bath shower mixer.

See page 49 for technical details on the Compact basin and page 48 for technical details on the Compact WC range.

WCs - Compact



All Britton WC fittings are factory set at 3L and 6L flush. They can be adjusted on site to flush at 2 1/2 L and 4 1/2 L.

COMPACT CLOSE COUPLED
BACK TO WALL WC

| | |
|-----------------------------|-----------|
| Cistern with cistern lid | CM.0007 |
| Standard pan | CM.0006 |
| Soft close seat | SS.1028 |
| Complete close coupled WC - | Image (C) |

COMPACT WALL HUNG WC

| | |
|--|-----------|
| Wall hung pan | CM.0005 |
| Concealed cistern tank with top/front access and dual flush button | W31A |
| Soft close seat | SS.1028 |
| Complete cistern, pan & seat - | Image (D) |

COMPACT BACK TO WALL WC

| | |
|---|-----------|
| Back to wall pan | CM.0004 |
| Concealed cistern tank with top/front access and rectangular dual flush plate | W32A |
| Soft close seat | SS.1028 |
| Complete pan & seat - | Image (E) |

* Concealed cistern must be ordered as a separate item to the WC pan. Please note that both the flush plate & push button cistern can be used with the back to wall and wall hung WCs.

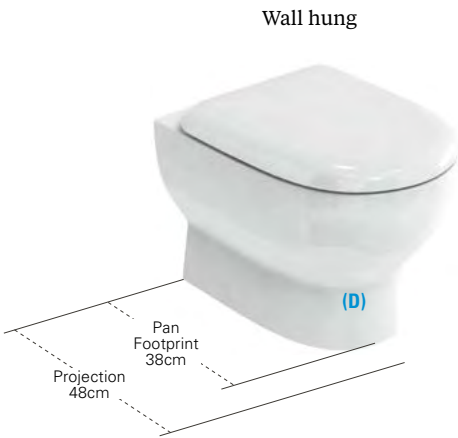

On all sanitaryware
See website for details

COMPACT & TALL BASINS &
PEDESTALS

| | | |
|------------|-----------|---------|
| 45cm basin | 40cm deep | CM.0001 |
| 55cm basin | 40cm deep | CM.0002 |
| 65cm basin | 40cm deep | CM.0003 |

| | | |
|-------------------|-----|---------|
| TALL pedestal | (A) | FP.1977 |
| STANDARD pedestal | (B) | FP.1032 |
| Semi pedestal | | SP.1033 |



Crystal Taps



Basin mixer
with pop-up waste
15.3cm x 5.2cm x 16.4cm
CTA2



Basin mixer
without pop-up waste
13.8cm x 5.2cm x 16.4cm
CTA1



Mini basin mixer
without pop-up waste
13.8cm x 4.8cm x 15cm
CTA8



Single lever
bath filler
19.6cm x 5.5cm x 16.6cm
CTA5



Bath filler
deck mounted
17.5cm x 23.2cm x 16.9cm
CTA6



Bidet mixer with
pop-up waste
13.3cm x 5.2cm x 16.4cm
CTA4



Tall basin mixer
without pop-up waste
13.7cm x 5.2cm x 32.4cm
CTA3



Single lever bath filler on
stand pipe
Floor standing
19.6cm x 5.5cm x 90.3cm
Bath filler CTA5
Stand pipe W24



Bath filler
on stand pipes
Floor standing
17.5cm x 23.2cm x 89.5cm
Bath filler CTA6
Stand pipes W7

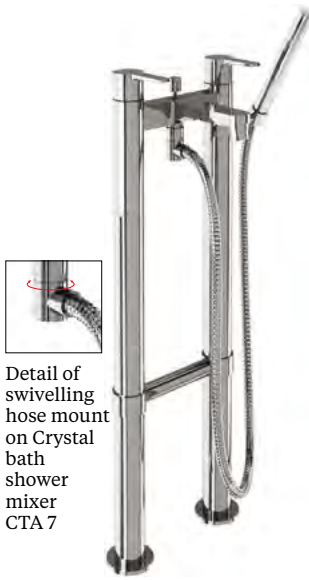

Bath shower mixer
on stand pipes
Floor standing
17.5cm x 30.2cm x 89.5cm
Bath filler CTA7
Stand pipes W7



Bath shower
mixer
Deck mounted
17.5cm x 30.2cm x 25cm
CTA7



Detail of
swivelling
hose mount
on Crystal
bath
shower
mixer
CTA 7

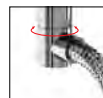

Detail of
swivelling
hose mount
on Crystal
bath
shower
mixer
CTA 7

Crystal Taps

Each range features extensive options including basin mixers with and without pop-up waste, tall options for vanity basins, mini options for cloakroom uses, bidet mixers, bath fillers and bath shower mixers which can be deck mounted or used with floor-standing legs to provide the ultimate luxury in your contemporary bathroom.



Sapphire Taps



Sapphire Basin & Bath Taps



Basin mixer
with pop-up waste
16.2cm x 5.2cm x 15.4cm
CTA11



Basin mixer
without pop-up waste
15cm x 5.2cm x 15.4cm
CTA9



Mini basin mixer
without pop-up waste
14.5cm x 4.8cm x 14.6cm
CTA10



Bidet mixer with
pop-up waste
13.3cm x 5.2cm x 15.4cm
CTA13



Single lever
bath filler
20cm x 55cm x 16.2cm
CTA14



Bath filler
deck-mounted
17.9cm x 23.2cm x 15.9cm
CTA15



Tall basin mixer
without pop-up waste
15cm x 5.2cm x 31.3cm
CTA12



Single lever bath filler on
stand pipe
Floor standing
20cm x 5.5cm x 89.8cm
Bath filler CTA14
Stand pipe W24



Bath filler
on stand pipes
Floor standing
17.9cm x 23.2cm x 89.5cm
Bath filler CTA15
Stand pipes W7



Bath shower mixer
on stand pipes
Floor standing
17.9cm x 30.2cm x 89.5cm
Bath filler CTA16
Stand pipes W7



Detail of
swivelling hose
mount



Bath shower
mixer
Deck mounted
17.9cm x 30.2cm x 25cm
CTA16



CLEANING MADE EASY
The easy-clean clip-on, clip-off brass basket mounting system.



Small rectangular wire basket
13cm x 11cm x 3.4cm A28CHR



Large rectangular wire basket
26cm x 12cm x 5.4cm A29CHR



Large deep rectangular wire basket
26cm x 12cm x 8.4cm A30CHR



Small corner wire basket
15cm x 15cm x 3.3cm A31CHR



Large corner wire basket
19cm x 19cm x 3.4cm A32CHR



Large deep corner wire basket
19cm x 19cm x 8.2cm A33CHR



Square, flat bottomed, basin bottle trap
36cm x 7cm x 17cm W17



Round, flat bottomed, basin bottle trap
36cm x 7cm x 18cm W13



Rounded bottle trap
37cm x 7cm x 20cm W14



Click-clack basin waste
Slotted for use with overflow basins
6cm x 6cm x 7cm W11



Click-clack basin waste
Unslotted for use with basins with no overflow
6cm x 6cm x 9cm W22



Flip top basin waste
Slotted for use with overflow basins
6cm x 6cm x 7cm W18



Cabinet basin waste bottle trap
Reduces space taken up by normal bottle trap inside cabinet
W26



Cleaning made easy
The clip-on, clip-off wire basket mounting system allows for easier cleaning



On all Crystal taps
See website for details

Accessories

Britton provides an extensive range of stylish and contemporary accessories in stainless steel, chromium plated brass and ceramic to turn your bathroom into both a beautiful and functional space. Combine soap dishes, tumblers, dispensers or WC brushes all in smooth white ceramic with cool stainless steel shelves.

For our full range of Britton accessories visit www.brittonbathrooms.com



FOR CUBE & FINE:

| | |
|------------|---------|
| 50cm basin | TR.1027 |
| 60cm basin | TR.1026 |

FOR CURVE:

| | |
|------------|---------|
| 50cm basin | TR.1029 |
| 60cm basin | TR.1028 |



Stainless steel shelf
With ceramic soap dish
D:11cm x W:10cm x H:5cm
BR1*+4



Offset stainless steel shelf
With ceramic soap dish
D:11cm x W:20cm x H:5cm
BR1*+6



Stainless steel shelf
With ceramic tumbler
D:11cm x W:10cm x H:11cm
BR2+4



Stainless steel shelf
With double ceramic tumblers
D:11cm x W:20cm x H:11cm
BR2+2+5*



Stainless steel shelf
With double ceramic soap dish
D:11cm x W:20cm x H:5cm
BR1*+1*+5*



Stainless steel toilet
roll holder
D:11cm x W:15cm x H:8cm
BR12*



Stainless steel shelf
With ceramic soap dish and
ceramic tumbler
D:11cm x W:20cm x H:11cm
BR1*+2+5*

*While stocks last



Offset stainless steel shelf
With ceramic tumbler
D:11cm x W:20cm x H:11cm
BR2+6



Stainless steel towel ring
18cm
BR18*



Stainless steel towel rail with shelf
Medium 35cm BR15
Long 55cm (pictured) BR8*



Offset stainless steel shelf and towel rail
With ceramic soap dish
Medium 35cm BR1*+10
Long 55cm (pictured)* BR1+9*



Offset stainless steel shelf and towel rail
With ceramic tumbler
Medium 35cm BR2+10
Long 55cm (pictured)*\$ BR2+9*



Stainless steel towel rail
Long 55cm (pictured) BR13*



Stainless steel towel rail with shelf
Long 55cm (pictured) BR8*

*While stocks last



Furniture

Britton offers fantastic furniture solutions with its Aqua-Cabinets range; the first furniture range specifically designed for the complexities of the bathroom environment. We provide ample storage solutions for your bathroom, making it both a beautiful and functional space. From fully fitted furniture to free-standing options packed with innovative features such as soft-close doors and drawers, internal lighting or wide opening doors each designed to pair with selected countertop basins. Every piece comes in five colours; White, Reef, Black, Ocean and Anthracite. Whatever your requirements for storage in your bathroom, Aqua Cabinets by Britton covers your needs and tastes perfectly.

All images within this brochure are, where possible, a true representation of our products. Some colours may vary. Please visit the website for more details or visit your local dealer for colour samples.

Clever features & smart details



ADJUSTABLE GLASS SHELVES
6mm shatterproof safety glass is used to improve visibility inside the units, and to improve hygiene and easy cleaning!



FIVE COATS OF PAINT
To keep your furniture looking its best five layers of paint are applied, with the top layer being UV resistant to protect against fading by sunlight.



SOFT-CLOSE DOORS & DRAWERS
All cabinets and furniture pieces are equipped with soft-close drawers and doors for that extra bit of luxury in your bathroom.



INTEGRATED BASINS
Choose from a range of basins, which cover the entire width of your furniture. This not only looks great with no joins, but also provides a great work-surface.



CABINET & DRAWER LIGHTING
A battery operated LED light illuminates the inside of your cabinet or drawer. No switches - our motion detector turns on the light with any movement.



MOOD LIGHTING
Mood lighting under all our mirrored units with lights - to create a warm designer feel within the bathroom.

Designed using the best materials

Modern materials that can cope with the demanding environment of a bathroom



CERAMIC

Ceramic is a remarkable material with unparalleled resistance to abrasion and staining. It has excellent strength and due to a quality manufacturing process, finished with a silica glaze, our basins have greater depth of colour and prevent porosity.

The Britton furniture range has been designed to provide both stylish and functional furniture, which is attractive and fit for purpose in the modern day bathroom.

SPACE

Designed with you in mind, the furniture pieces all provide maximum storage abilities, some with wide open doors and curved edges to allow for great accessibility. Integrated basins and worktops also provide ample space for all bathroom necessities.

BATHROOM SPECIFIC

Crafted using moisture resistant materials, all furniture is resistant to warm and moist environments. Finished with UV resistant lacquers, any natural or illuminated light will also not damage your furniture or cause the colours to fade.

QUATTROCAST®

Quattrocast is a modern material perfectly adapted for use in the bathroom. Finished with a coat of polyester resin, the basins have a durable layer impervious to bacteria. The base layer is manufactured using exceptionally high-quality materials and allows us to design sharply defined basins with long runs of worktops, perfect for our free-standing furniture pieces. These shapes would be impossible to achieve with traditional materials.



Freestanding Furniture

COMPACT

A stunning collection from Britton Aqua-Cabinets comes in the form of the Compact furniture range, including wall-hung or free-standing curved vanity units in either 60cm or 90cm with integral Quattrocast basins. These beautiful additions to the range feature deep soft-close drawers for maximum storage.

Pages 64-66



GULLWING & ARC

Curvaceous free-standing furniture units with integral basins. The rounded doors open wide, allowing for greater use of space and functionality. Motion sensed lighting is optional and soft-closing doors and a glass shelf make this piece an ingenious and innovative stylish storage solution.

Pages 67-71



D45

The D45 units can be paired with other furniture units from the Aqua-Cabinets range to create a suitable storage solution tailored to your specific needs. Choose from a range of sizes 60cm, 90cm or 120cm as either a single or double basin option. Also available with motion sensed lighting.

Pages 72-76

Fitted Furniture

D30

D30 Aqua bathroom furniture is the classic format of the modern bathroom. The base cabinets are only 30cm deep, with generous semi-inset basins. The range is versatile with the option to combine drawers, cupboard units and WC's. For maximum storage the range includes a 190cm tall unit. Also available are a complete set of mirrors and mirrored cabinets.

Pages 77-87



Mix & Match

VARIOUS

Aqua-Cabinets have been designed so that you can match the D45 base units with the D30 base units to maximise function storage space.

Pages 90-93

Cloakroom

VARIOUS

Perfect for those rooms where space is a challenge - Aqua Cabinets cloakroom furniture offers wall hung and floor standing slimline units offering a solution for every space no matter how small.

The basins are large enough for a main bathroom and there is the luxury of ample storage in the cloakroom range.

Pages 94-99



NEW

COMPACT A stunning collection from Britton, comes in the form of the Compact furniture range, including wall-hung or free-standing vanity units in either 600mm or 900mm with basins in either Quattrocast or Ceramic. The most recent addition to the range is the fitted compact WC and basin units available in the colours of the range. Perfect for smaller bathrooms where storage is as important as style.



Compact white semi recessed basin shown with 60cm semi recessed basin unit and 60cm back to wall WC unit (including cistern tank and front dual flush plate), with compact back to wall WC with soft close seat



Compact 1200mm work top
W: 1200mm, D: 230mm, H 18mm
Code:T36z*
Available in all four colours

Compact 600mm work top
W: 600mm, D: 230mm, H 18mm
Code:T35z*
Available in all four colours



Compact Semi recessed basin 55cm
W: 550mm, D: 360mm, H 150mm
Code: CM.0008



Compact 60cm semi-recessed basin unit, white with two soft close doors
W: 600mm, D: 230mm, H 820mm
Code: CM5W



Compact 60cm semi-recessed basin unit, anthracite grey with two soft close doors
W: 600mm, D: 230mm, H 820mm
Code: CM5G



Compact 60cm semi-recessed basin unit, black with two soft close doors
W: 600mm, D: 230mm, H 820mm
Code: CM5B



Compact 60cm semi-recessed basin unit, ocean with two soft close doors
W: 600mm, D: 230mm, H 820mm
Code: CM5O



Compact 60cm back to wall WC unit (including cistern tank and front dual flush plate), white
W: 600mm, D: 230mm, H 820mm
Code: CM6W

Shown with back to wall WC



Compact 60cm back to wall WC unit (including cistern tank and front dual flush plate), anthracite grey
W: 600mm, D: 230mm, H 820mm
Code: CM6G

Shown with back to wall WC



Compact 60cm back to wall WC unit (including cistern tank and front dual flush plate), black
W: 600mm, D: 230mm, H 820mm
Code: CM6B

Shown with back to wall WC



Compact 60cm back to wall WC unit (including cistern tank and front dual flush plate), ocean
W: 600mm, D: 230mm, H 820mm
Code: CM6O

Shown with back to wall WC



Compact 60cm wall hung unit (including cistern tank and front dual flush plate), white
W: 600mm, D: 230mm, H 820mm
Code: CM6W

Shown with wall hung WC



Compact 60cm wall hung unit (including cistern tank and front dual flush plate), anthracite grey
W: 600mm, D: 230mm, H 820mm
Code: CM6G

Shown with wall hung WC



Compact 60cm wall hung unit (including cistern tank and front dual flush plate), black
W: 600mm, D: 230mm, H 820mm
Code: CM6B

Shown with wall hung WC



Compact 60cm wall hung unit (including cistern tank and front dual flush plate), ocean
W: 600mm, D: 230mm, H 820mm
Code: CM6O

Shown with wall hung WC

Compact Cabinets & Mirrors



Compact 60cm two drawer floor standing cabinet with soft-close drawers
W: 60cm, D: 40cm, H 85cm (with basin)
Code: CM1z*



Compact 60cm one drawer wall hung cabinet with soft-close drawers
W: 60cm, D: 40cm, H 39cm (with basin)
Code: CM3z*



Compact 60cm illuminated wall mirror with LED lights, LED mood lights & infrared sensor
W: 60cm, D: 15cm, H 71cm
Code: M50z*



Compact 60cm mirrored wall cabinet with two soft close doors & glass shelf
W: 60cm, D: 15cm, H 75cm
Code: C50z*



Compact 60cm Quattrocast basin with overflow, 1 tap hole only
W: 60cm, D: 40cm, H: 30cm
Code: Q6040



Cabinet light
22cm light for inside cabinets. The LED light switches on via a movement sensor and switches off automatically after 15 seconds after no movement is detected. Powered by four AAA batteries
Code: LED1



Demisting pad
Sticks to the rear of the mirror, it prevents the mirror from fogging up in a 35cm² area!
Code: X01A



Colours



White



Anthracite Grey



Black



Ocean

* To order the correct furniture colour simply remove the 'z' from the product code and replace it with 'W' for White, 'B' for Black, 'G' for Anthracite Grey or 'O' for Ocean.



ARC 90cm free-standing furniture unit available in both left and right handed options. A useful combination of drawers, shelving and open wide doors, this furniture piece gives great storage potential. Fit with additional motion sensored internal lighting on a timer to automatically switch off when no movement is detected. Pair with 90cm Arc Quattrocast basin which gives a generous depth of 45cm.



Gullwing & Arc Floor Cabinets & Basins



Gullwing 60cm floor standing cabinet
with two soft close doors & glass shelf
W: 60cm, D: 45cm, H 86cm (with basin)
Code: G41z*



Arc 90cm left floor standing cabinet
with three soft close doors, 2 glass shelves & a soft close drawer
W: 90cm, D: 45cm, H 86cm (with basin)
Code: C31z*



Arc 90cm right floor standing cabinet
with three soft close doors, 2 glass shelves & a soft close drawer
W: 90cm, D: 45cm, H 86cm (with basin)
Code: C42z*



Gullwing 60cm Quattrocast basin
with overflow, 1 tap hole only
W: 60cm, D: 45cm, H 3cm
Code: Q6045G

Colours

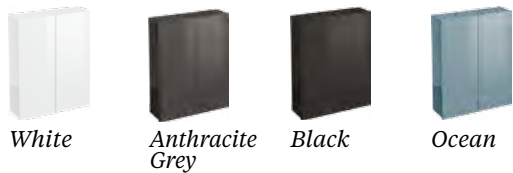

* To order the correct furniture colour simply remove the 'z' from the product code and replace it with 'W' for White, 'B' for Black, 'G' for Anthracite Grey or 'O' for Ocean.



Cabinet light
22cm light for inside cabinets. The LED light switches on via a movement sensor and switches off automatically after 15 seconds after no movement is detected. Powered by four AAA batteries
Code: LED1

All cabinet doors can be installed with the hinges on the left or the right.
For taps & wastes see pages 50-55.
For detailed measurements and specifications see: www.brittonbathrooms.com/aquacabinets/gullwing-floor

Gullwing & Arc Wall Cabinets & Mirrors



30cm Wall cupboard
with soft close door & two glass shelves
W: 30cm, D: 15cm, H 75cm
Code: C10z*



30cm Mirrored wall cupboard
with soft close door & two glass shelves
W: 30cm, D: 15cm, H 75cm
Code: C30z*



60cm Wall cupboard
with two soft close doors & two glass shelves
W: 60cm, D: 15cm, H 75cm
Code: C20z*



60cm Mirrored wall cupboard
with two soft close doors & two glass shelves
W: 60cm, D: 15cm, H 75cm
Code: C40z*



50cm illuminated wall mirror
with LED lights, LED mood lights & infrared sensor
W: 50cm, D: 15cm, H 74cm
Code: M10z*



60cm illuminated wall mirror
with LED lights, LED mood lights & infrared sensor
W: 60cm, D: 15cm, H 74cm
Code: M20z*



90cm illuminated wall mirror
with LED lights, LED mood lights & infrared sensor
W: 90cm, D: 15cm, H 74cm
Code: M30z*



Demisting pad
Sticks to the rear of the mirror, it prevents the mirror from fogging up in a 35cm² area!
Code: X01A

Colours

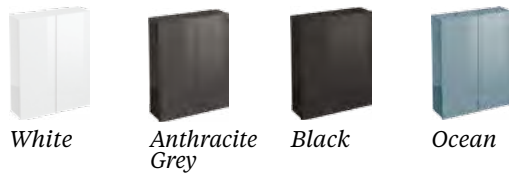

* To order the correct furniture colour simply remove the 'z' from the product code and replace it with 'W' for White, 'B' for Black, 'G' for Anthracite Grey or 'O' for Ocean.



FURNITURE

Colours

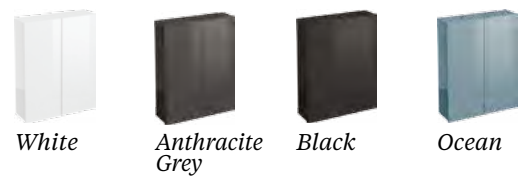

* To order the correct furniture colour simply remove the 'z' from the product code and replace it with 'W' for White, 'B' for Black, 'G' for Anthracite Grey or 'O' for Ocean.

As shown, this page: D45 90cm ceramic basin (Q9045 page 75) 90cm black double drawer cabinet D46B; page 76). Accessories page 56. Tap page 50.



FURNITURE

D45 CERAMIC This range boasts traditional ceramic basins. The basins are manufactured from Fine Fire Clay. This material has the benefit of greater stability during firing in the kiln, allowing us to create exceptionally large ceramic pieces. The worktops are a generous 45cm deep, and come in a variety of lengths and options - from 60cm to 120cm long, with single or double bowls. The basins are fully formed from within the worktop for a seamless finish.



On all furniture
See website for details

As shown: D45 90cm illuminated mirror (M300; page 76) D45 90cm ceramic basin (C9045; page 75) D45 90cm drawer cabinets (D46O; page 75). Accessories page 56. Taps page 50.



Colours

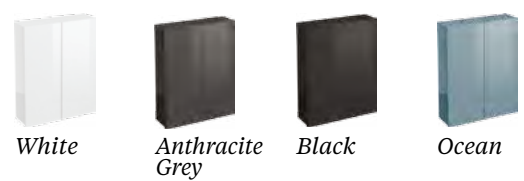

* To order the correct furniture colour simply remove the 'z' from the product code and replace it with 'W' for White, 'B' for Black, 'G' for Anthracite Grey or 'O' for Ocean.

As shown, this page: D45 120cm ceramic double basin (C1245D; page 75) two of D45 60cm drawer cabinets (D45B; page 75).
Accessories page 56. Taps page 50.

D45 Ceramic Basins



D45 60cm Ceramic basin with overflow, 1 tap hole only
W: 60cm, D: 45cm, H 2cm
Code: C6045



D45 90cm Ceramic basin with overflow, 1 tap hole only
W: 90cm, D: 45cm, H: 2cm
Code: C9045



D45 120cm Ceramic basin with overflow, 1 tap hole only
W: 120cm, D: 45cm, H: 2cm
Code: C1245



D45 120cm Ceramic double basin with overflows, 2 x 1 tap hole only
W: 120cm, D: 45cm, H: 2cm
Code: C1245D

D45 Floor Standing Cabinets



D45 30cm floor standing cupboard & drawer unit with soft close door, glass shelf & soft close drawer
W: 60cm, D: 45cm, H 82cm
Code: D41z*



D45 60cm floor standing cupboard cabinet with two soft close doors & glass shelf
W: 60cm, D: 45cm, H 82cm
Code: D42z*



D45 90cm floor standing cupboard cabinet with two soft close doors & glass shelf
W: 90cm, D: 45cm, H 82cm
Code: D43z*



D45 60cm floor standing double drawer unit with one external & one internal soft close drawers
W: 60cm, D: 45cm, H 82cm
Code: D45z*



Cabinet light
22cm light for inside cabinets. The LED light switches on via a movement sensor and switches off automatically after 15 seconds after no movement is detected. Powered by four AAA batteries
Code: LED1



Demisting pad
Sticks to the rear of the mirror, it prevents the mirror from fogging up in a 35cm² area
Code: X01A

Colours

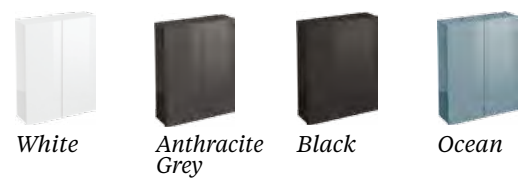

* To order the correct furniture colour simply remove the 'z' from the product code and replace it with 'W' for White, 'B' for Black, 'G' for Anthracite Grey or 'O' for Ocean.

D45 Floor Standing Combinations



120cm combination including:
60cm cupboard, 2 x 30cm triple drawer units
Code: D42z* + D44z* + D44z*



120cm combination including:
2 x 60cm double drawer units
Code: D45z* + D45z*



120cm combination including:
60cm cupboard, 2 x 30cm cupboard & drawer units
Code: D42z* + D41z* + D41z*

D45 Wall Cabinets & Mirrors



30cm Wall cupboard
with soft close door & two glass shelves
W: 30cm, D: 15cm, H 75cm
Code: C10z*



30cm Mirrored wall
cupboard
with soft close door & two glass shelves
W: 30cm, D: 15cm, H 75cm
Code: C30z*



60cm Wall cupboard
with two soft close doors & two glass shelves
W: 60cm, D: 15cm, H 75cm
Code: C20z*



60cm Mirrored wall
cupboard
with two soft close doors & two glass shelves
W: 60cm, D: 15cm, H 75cm
Code: C40z*



50cm illuminated wall
mirror
with LED lights, LED mood
lights & infrared sensor
W: 50cm, D: 15cm, H 74cm
Code: M10z*



60cm illuminated wall
mirror
with LED lights, LED mood
lights & infrared sensor
W: 60cm, D: 15cm, H 74cm
Code: M20z*



90cm illuminated wall
mirror
with LED lights, LED mood lights
& infrared sensor
W: 90cm, D: 15cm, H 74cm
Code: M30z*



120cm illuminated wall
mirror
with LED lights, LED mood lights
& infrared sensor
W: 120cm, D: 15cm, H 74cm
Code: M40z*



Fitted furniture

The illusion of space

A fitted bathroom with a straight line of base and wall cabinets covering one wall, often looks bigger than one with free-standing individual pieces. The uninterrupted straight lines accentuate the length of the interior and provide clever storage space in the modern bathroom.

STEP 1 CHOOSE YOUR COLOUR

Our fitted furniture is available in four colours: White, Anthracite Grey, Black and Ocean.

STEP 2 WORK OUT THE SIZE

Choose the length of your furniture run - 60cm, 90cm, 120cm, 150cm or 180cm.

STEP 3 CHOOSE YOUR BASE UNITS

Choose your base units to add up to the length of your run. You will need at least one basin unit, possibly a WC unit, and then make up the rest of the run with low or tall storage units.

STEP 4 SELECT YOUR BASIN

You can choose from a Quattrocast top with an integrated basin, or a ceramic semi-inset basin with a wooden worktop. The Quattrocast should be the same length as the sum of your low storage, WC and basin units combined. For example, a 60cm basin, plus a 60cm WC plus a 30cm low storage unit requires a 150cm Quattrocast top.

*While stocks last

STEP 5 WHICH WORKTOP?

If you are using a ceramic semi-inset basin then choose a worktop to cover the run of cabinets. The ceramic basin will be cut into the worktop during installation.

STEP 6 ADD WALL UNITS

Choose wall units to go above your base units. Combinations of 30cm or 60cm wide cupboards with or without mirror doors. Alternatively choose a mirror or illuminated mirror - size options of 50cm, 60cm, 90cm or 120cm wide.

STEP 7 FINISHING TOUCHES

Include a demisting pad for fitting behind the mirror to stop your mirror misting up. The mirror will need to be wired to the mains. Add internal lighting to cabinets to illuminate your storage when movement is detected.

As shown opposite page: D30 semi recessed basin cabinet (D370)
D30 30cm floor standing cupboard cabinet (2 x D31O)
D30 60cm mirrored wall cupboard (C40O)
D30 wall cupboard (2 x C10O)
D30 30cm cupboard cabinet (D31O)
D30 back to wall cabinet with flush plate (W32O)





D30 FITTED BATHROOM FURNITURE D30 Aqua bathroom furniture is the classic format of the modern bathroom. The base cabinets are only 30cm deep, with generous semi-inset basins. The essence of this range is its versatility - the units can be combined to fit exactly into the space available, combining drawers and cupboards, basins and WC's. For maximum storage the range even includes a 190cm tall unit. To complete the look the range has a complete set of wall cabinets and mirrors. The illuminated mirrors provide a good light for shaving (or even putting on a bit of lipstick).

Colours

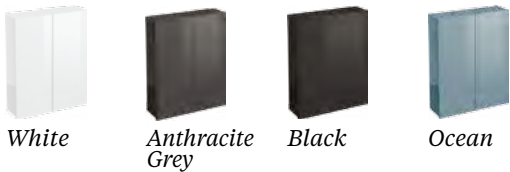

* To order the correct furniture colour simply remove the 'z' from the product code and replace it with 'W' for White, 'B' for Black, 'G' for Anthracite Grey or 'O' for Ocean.

Opposite page: 150cm combination of 150cm left quattrocast basin (Q1530L), 60cm semi recessed unit (D37R), 60cm floor standing cabinet (D34R), D30 30cm floor standing cupboard cabinet (D31R), 60cm illuminated wall mirror (M20R).

This page, top left: 120cm combination of 30cm drawer unit, 60cm semi recessed unit, and 30cm double shelf unit, with 120cm work top, 55cm Cube semi recessed basin.

Top right: 120cm combination of tall unit, 60cm semi recessed unit, 30cm drawer unit, with 90cm Quattrocast® basin left.

See page 64 for technical details on the Compact furniture range.





This page: 120cm combination of 60cm semi recessed unit, 60cm WC unit with flush button, with 120cm Quattrocast® basin left.

See page 64 for technical details on the Compact furniture range.



This page: 120cm combination of 60cm semi recessed unit with flush button, 120cm Quattrocast basin left, with D30 30cm floor standing tall cupboard cabinet.

D30 Back to Wall WC & Bidet Cabinets



60cm back to wall cabinet with concealed cistern tank with top/front access and dual flush button
W: 60cm, D: 30cm, H 82cm

| | |
|------------------------|-------|
| Cabinet | *W31z |
| Concealed cistern tank | W32A |



60cm back to wall cabinet with concealed cistern tank with top/front access and rectangular dual flush plate
W: 60cm, D: 30cm, H 82cm

| | |
|------------------------|-------|
| Cabinet | *W32z |
| Concealed cistern tank | W32A |



60cm back to wall bidet cabinet
W: 60cm, D: 30cm, H 82cm
Code: B31z*

D30 Wall Hung WC & Bidet Cabinet



60cm wall hung WC cabinet including 3 / 6 litre cistern & flush button and internal metal mounting frame
W: 60cm, D: 30cm, H 82cm
W33z
W33A Steel frame for WC Unit



60cm wall hung WC cabinet including 3 / 6 litre cistern & flush plate and internal metal mounting frame
W: 60cm, D: 30cm, H 82cm
W32z
W33A Steel frame for WC Unit



60cm wall hung bidet cabinet including internal metal mounting frame
W: 60cm, D: 30cm, H 82cm
B31z
B32A Steel frame for bidet unit

*Prices exclude WC's and Bidets

Colours

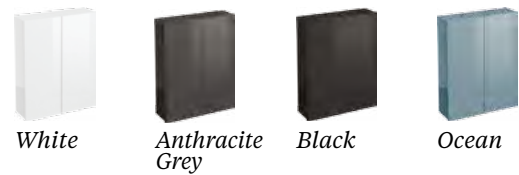

* To order the correct furniture colour simply remove the 'z' from the product code and replace it with 'W' for White, 'B' for Black, 'G' for Anthracite Grey or 'O' for Ocean.



All Britton WC fittings are factory set at 3L and 6L flush. They can be adjusted on site to flush at 2½L and 4½L.



All Britton Cistern fittings are WRAS approved

D30 Floor Standing Cabinets



D30 60cm semi-recessed basin cabinet with two soft close doors & glass shelf
W: 60cm, D: 30cm, H 82cm
Code: D37z*

* excludes basin



D30 60cm floor standing cupboard cabinet with two soft close doors & two glass shelves
W: 60cm, D: 30cm, H 82cm
Code: D33z*



D30 60cm floor standing cupboard cabinet with soft close doors, glass shelf & soft close drawer
W: 60cm, D: 30cm, H 82cm
Code: D34z*



D30 30cm floor standing cupboard cabinet with soft close doors & two glass shelves
W: 30cm, D: 30cm, H 82cm
Code: D31z*



D30 30cm floor standing cupboard cabinet with soft close door, glass shelf & soft close drawer
W: 30cm, D: 30cm, H 82cm
Code: D32z*



D30 30cm floor standing tall cupboard cabinet with two soft close doors & four glass shelves
W: 30cm, D: 30cm, H 190cm
Code: D35z*



Cabinet basin waste bottle trap
Reduces the space taken up by a normal bottle trap inside your cabinet
Code: W26

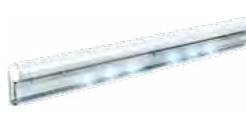

Cabinet light
22cm light for inside cabinets. The LED light switches on via a movement sensor and switches off automatically after 15 seconds after no movement is detected. Powered by four AAA batteries
Code: LED1



Plumbing cover
W: 90cm, D: 17cm, H 25cm
Code: X02G

Plumbing cover is only available in Anthracite

D30 60cm Basins



Fine 60cm ceramic semi-recessed basin
with overflow, 1 tap hole only
see page 13 & 16
W: 60cm, D: 45cm, H 2cm
Code: 40.6610



Cube 60cm ceramic semi-recessed basin
with overflow, 1 tap hole only
see page 24 & 28
W: 60cm, D: 45cm, H 2cm
Code: 20.1954



Curve 60cm ceramic semi-recessed basin
with overflow, 1 tap hole only
see page 40
W: 60cm, D: 45cm, H 2cm
Code: 30.1965



60cm Quattrocast basin
with overflow, 1 tap hole only
see page 40
W: 60cm, D: 30cm, H 3cm
Code: Q6030

D30 90cm Basins



D30 90cm left Quattrocast basin
with overflow, 1 tap hole only
W: 90cm, D: 30cm, H 3cm
Code: Q9030L

Available while stocks last



D30 90cm right Quattrocast basin
with overflow, 1 tap hole only
W: 90cm, D: 30cm, H 3cm
Code: Q9030R

Available while stocks last

D30 120cm Basins



D30 120cm left Quattrocast basin
with overflow, 1 tap hole only
W: 120cm, D: 30cm, H 3cm
Code: Q1230L



D30 120cm right Quattrocast basin
with overflow, 1 tap hole only
W: 120cm, D: 30cm, H 3cm
Code: Q1230R

D30 150cm Basins



D30 150cm left Quattrocast basin
with overflow, 1 tap hole only
W: 150cm, D: 30cm, H 3cm
Code: Q1530L



D30 150cm right Quattrocast basin
with overflow, 1 tap hole only
W: 150cm, D: 30cm, H 3cm
Code: Q1250R

D30 Wall Cabinets



30cm Wall cupboard
with soft close door & two glass shelves
W: 30cm, D: 15cm, H 75cm
Code: C10G*



30cm Mirrored wall cupboard
with soft close door & two glass shelves
W: 30cm, D: 15cm, H 75cm
Code: C30G*



60cm Wall cupboard
with two soft close doors & two glass shelves
W: 60cm, D: 15cm, H 75cm
Code: C20G*



60cm Mirrored wall cupboard
with two soft close doors & two glass shelves
W: 60cm, D: 15cm, H 75cm
Code: C40G*

D30 Worktops



60cm Worktop
W: 60cm, D: 30cm, H 2cm
Code: T31G*



90cm Worktop
W: 90cm, D: 30cm, H 2cm
Code: T32G*



120cm Worktop
W: 120cm, D: 30cm, H 2cm
Code: T33G*



150cm Worktop
W: 150cm, D: 30cm, H 2cm
Code: T34G*

Colours



White



Anthracite Grey



Black



Ocean

* To order the correct furniture colour simply remove the 'z' from the product code and replace it with 'W' for White, 'B' for Black, 'G' for Anthracite Grey or 'O' for Ocean.

All cabinet doors can be installed with the hinges on the left or the right.

For detailed measurements and specifications see: www.brittonbathrooms.com/aquacabinets/wall-cabinets

D30 Illuminated Mirrors



50cm illuminated wall mirror
with LED lights, LED mood lights & infrared sensor
W: 50cm, D: 15cm, H 74cm
Code: M10z*



60cm illuminated wall mirror
with LED lights, LED mood lights & infrared sensor
W: 60cm, D: 15cm, H 74cm
Code: M20z*



90cm illuminated wall mirror
with LED lights, LED mood lights & infrared sensor
W: 90cm, D: 15cm, H 74cm
Code: M30z*



120cm illuminated wall mirror
with LED lights, LED mood lights & infrared sensor
W: 120cm, D: 15cm, H 74cm
Code: M40z*

Mirrors also available in the
Compact range. Page 66.



Demisting pad
Sticks to the rear of the mirror, it prevents
the mirror from fogging up in a 35cm² area!
Code: X01A

Cabinet Lighting



Cabinet light
22cm light for inside cabinets. The LED light
switches on via a movement sensor and
switches off automatically after 15 seconds
after no movement is detected. Powered by
four AAA batteries
Code: LED1

The Magic of Light

The success of a bathroom design is critically dependent on lighting. Not only does it define the interior space, but the bathroom is essential for those important grooming rituals.

Britton has developed a unique lighting system. To soften harsh shadows a row of white LED lights run along the front top edge, which is then reflected back by the mirror as well - these multiple strips of crisp light provide the optimum light levels. The 'multiple' sources of light mimic sophisticated photographic portraiture lighting set ups.

A further row of white LED lights run along the bottom edge of the mirror. This illuminates the basin/work top area. The multiplicity of light sources not only creates a perception of space, but softens the mood of the living space.

A movement sensor switch is used as the on/off control - this means the lighting can be controlled by the wave of a hand inside the bathroom, rather than having the switch outside (or controlled by a nasty pull cord hanging from the ceiling).

The demisting pad prevents the mirror 'fogging up' if the bath or shower is used. It fits onto the back of the mirror.



Under-canopy LED lighting



LED mood lighting on underside of mirror

Colours

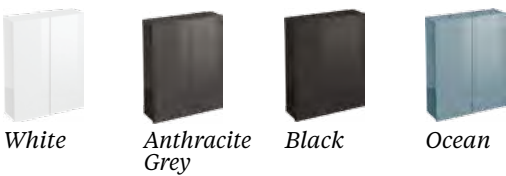

* To order the correct furniture colour simply remove the 'z' from the product code and replace it with 'W' for White, 'B' for Black, 'G' for Anthracite Grey or 'O' for Ocean.

Create your bathroom from a series of storage units and work surfaces to include counter-top basins. Each unit comes in a choice of five colours; Anthracite as shown here, Ocean, White, Black and Reef (while stocks last). Specifically designed around you and your lifestyle, you can create a bathroom to match your own individual needs and tastes.



D30 tall unit with doors that can be hinged left or right



60cm double mirrored door wall cabinet



60cm double door wall cabinet

D30 120cm Quattrocast left handed basin



D30 semi-recessed basin unit without worktop excluding basin



D30 back-to-wall WC unit with push button excluding WC & worktop

Colours

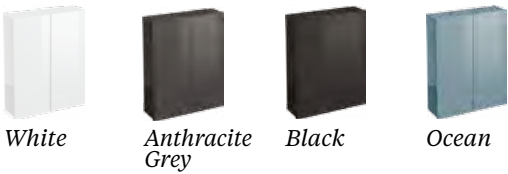

* To order the correct furniture colour simply remove the 'z' from the product code and replace it with 'W' for White, 'B' for Black, 'G' for Anthracite Grey or 'O' for Ocean.

Opposite page: 30cm tall unit, 60cm mirrored wall cabinet, 60cm wall cabinet. 60cm semi-recessed unit with 120cm left-handed Quattrocast basin, Sapphire basin mixer without pop-up waste, 60cm WC unit with flush button, Cube back-to-wall WC with Carbamide soft-close seat.

See page 78 for technical details on fitted furniture.





ILLUSION OF SPACE

More is less! A 'fitted' bathroom with a straight line of base and wall cabinets covering one wall often looks bigger than one with free standing individual pieces.

The uninterrupted straight lines accentuates the length of the interior - a clever trick of the eye. The real beauty is that a fitted look also solves the problem of storage space in the modern bathroom.

UNITS USED IN THIS BATHROOM



30cm tall unit
Code: D35B



60cm wide mirrored wall cabinet
Code: C40B



60cm wide mirrored wall cabinet
Code: C40B



60cm back to wall WC with flush plate
Code: W32B*
* excludes WC



60cm double door unit and 60cm Quattrocast® Basin
Code: D42B



60cm worktop
Code: T31B

Colours



White



Anthracite Grey



Black



Ocean

* To order the correct furniture colour simply remove the 'z' from the product code and replace it with 'W' for White, 'B' for Black, 'G' for Anthracite Grey or 'O' for Ocean.



MIX & MATCH

Britton have been designed so that you can match the D450 base units with the D300 base units to maximise function storage space.

A combination of base units with the wall cabinets and mirrors gives the bathroom an integrated and fully designed look.

UNITS USED IN THIS BATHROOM



60cm wide wall cabinet
Code: C20W



30cm wide wall cabinet
Code: C10W



90cm wide illuminated mirror
Code: M30W



60cm back to wall WC with flush button
Code: W31W*
* excludes WC



30cm unit with double shelf
Code: C30W



90cm Arc cabinet and Quattrocast® 90 basin
90cm Arc Quattrocast basin Q9045R
30cm drawer unit D41W
60cm Arc cabinet C4RW



90cm worktop
Code: T32W

Colours



White



Anthracite Grey



Black



Ocean

* To order the correct furniture colour simply remove the 'z' from the product code and replace it with 'W' for White, 'B' for Black, 'G' for Anthracite Grey or 'O' for Ocean.

Compact 25



COMPACT The Compact 25 has a projection of only 25cm, making it ideal for long, narrow cloakrooms. The width of 50.5cm is sufficient to still make this basin function very well for washing hands. If you have the luxury of a slightly wider cloakroom, the Compact 30.5 allows that slightly more spacious washing area. The basins (which are handed - specify the tap on the left or on the right) are made from glazed ceramic. The cabinets are available as either a wall hung or floor standing unit. The cabinet has a glass shelf and soft close hinges. The door is reversible to open either left or right.

As shown: Compact 25 cloakroom left basin CR.1730
Compact 25 ocean wall hung cabinet R10W.

Colours

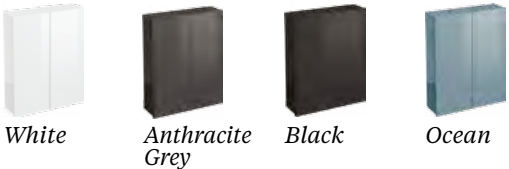

* To order the correct furniture colour simply remove the 'z' from the product code and replace it with 'W' for White, 'B' for Black, 'G' for Anthracite Grey or 'O' for Ocean.

25CM DEEP CABINETS & BASINS



Compact 25 Cloakroom basin left
with overflow, 1 tap hole only
W: 50.5cm, D: 25cm, H 15cm
Code: CR.1730



Compact 25 Cloakroom basin right
with overflow, 1 tap hole only
W: 50.5cm, D: 25cm, H 15cm
Code: CR.1731



Compact 25 floor mounted Cloakroom cabinet
with soft close door & glass shelf
W: 49cm, D: 21cm, H 77cm
Code: R20z*



Compact 25 wall mounted Cloakroom cabinet
with soft close door & glass shelf
W: 49cm, D: 21cm, H 51cm
Code: R10z*

Compact 30.5



WALL HUNG OR FLOOR STANDING The Compact cloakroom cabinets come in two forms: wall hung for an ultra modern look, or floor standing for homes for a more traditional look (and useful for cloakrooms with plasterboard walls) Both cabinets also come in 25cm depth or 30.5cm depth.

As shown: Compact 30.5 cloakroom left basin CR.1731
Compact 30.5 white floor mounted cabinet R40W.

Colours

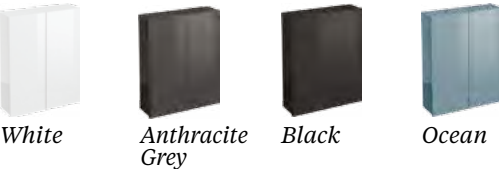

* To order the correct furniture colour simply remove the 'z' from the product code and replace it with 'W' for White, 'B' for Black, 'G' for Anthracite Grey or 'O' for Ocean.

30.5CM DEEP CABINETS & BASINS



Compact 30.5 Cloakroom basin left
with overflow, 1 tap hole only
W: 50.5cm, D: 30.5cm, H 15cm
Code: CR.1976



Compact 30.5 Cloakroom basin right
with overflow, 1 tap hole only
W: 50.5cm, D: 30.5cm, H 15cm
Code: CR.1975



Compact 30.5 floor mounted Cloakroom cabinet
with soft close door & glass shelf
W: 49cm, D: 27cm, H 77cm
Code: R40z*



Compact 30.5 wall mounted Cloakroom cabinet
with soft close door & glass shelf
W: 49cm, D: 27cm, H 51cm
Code: R30z*

All-in-One



As shown: Compact 25 cloakroom left basin CR.1730, ALLinONE cabinet R50R.

ALL-IN-ONE A cloakroom always has space as a challenge. The All-in-One is an ingenious solution! The unit is 50cm wide, and only 25cm deep. Yet not only does it contain a very useful storage cabinet underneath the ceramic basin, but the toilet roll and the brush and holder is contained within the space of the cabinet. The brush and toilet roll side can be mounted either on the left or the right hand side of the unit. The door is reversible to open left or right. The unit is floor standing, and contains one glass shelf.

25CM DEEP CABINETS & BASINS



Compact 25 Cloakroom basin left
with overflow, 1 tap hole only
W: 50.5cm, D: 25cm, H 15cm
Code: CR.1730



Compact 25 Cloakroom basin right
with overflow, 1 tap hole only
W: 50.5cm, D: 25cm, H 15cm
Code: CR.1731



ALLinONE floor standing cabinet
includes brass WC brush & toilet paper roll
W: 49cm, D: 21cm, H 77cm
Code: R50z**
** excludes basin

Aquacube



AQUACUBE The AquaCube unit is that special combination of a unit small enough for a cloakroom yet with a decent size basin which would not embarrass a main bathroom. The basins (and there are three options) are made from glazed ceramic, which are mounted on a wall fixed cabinet big enough for most essentials. The cabinet has soft close hinges. The door is reversible to open left hand or right hand. Matching mirrors and cabinets are available - see pages 14 and 15.

As shown: Curve 50cm basin 30.1967, Aquacube cabinet R60B.

Colours

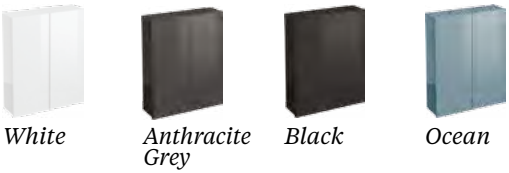

* To order the correct furniture colour simply remove the 'z' from the product code and replace it with 'W' for White, 'B' for Black, 'G' for Anthracite Grey or 'O' for Ocean.

For detailed measurements and specifications see: www.brittonbathrooms.com/aquacabinets/aquacube

31CM DEEP CABINETS & BASINS



Fine 50cm basin
with overflow, 1 tap hole only
see page 15 & 16
W: 50cm, D: 40cm, H 15cm
Code:40.1974



Cube 50cm basin
with overflow, 1 tap hole only
see page 22 & 28
W: 50cm, D: 40cm, H 15cm
Code:20.1956



Curve 50cm basin
with overflow, 1 tap hole only
W: 50cm, D: 40cm, H 15cm
Code: 30.1967



Aquacube wall hung cabinet
with soft close door
W: 39cm, D:31cm, H48cm
Code: R60z**
** excludes basin

Floor Mounted Tablet



As shown: Tablet floorstanding black W35B
(see page 40 for Curve back to wall pan & soft close seat).

Colours



* To order the correct furniture colour simply remove the 'z' from the product code and replace it with 'W' for White, 'B' for Black, 'G' for Anthracite Grey or 'O' for Ocean.

All Britton Cistern fittings are WRAS approved



THE TABLET A 21st century solution for the contemporary bathroom. The TABLET is a wc furniture unit designed to maximise space, with only a 15cm projection from the back wall. The ingenious feature is the reflective glass front. Made of hard wearing safety glass, with a gloss white backing, the Tablet is highly functional whilst, at the same time, increasing the perception of space within the bathroom. The TABLET is available in two options: a floor standing back to wall pan version, and a wall hung pan option with integrated steel frame for worry free rigidity and strength. The WRAS approved cistern fittings are operated from a rectangular chrome flush plate cleverly situated on the top surface. The fittings feature a water saving 3 and 6 litre flush. The carcass is colour coordinated with the AquaCabinet base and wall units. Designed to provide easy access to the internal cistern for care – free maintenance and quick installation.

The tall pan is not available as an option with the Tablet. The Tablet can only be used with a standard height pan.



Floor mounted tablet
with 3 / 6 litre cistern & dual flush plate
W: 55cm, D: 15cm, H 90cm
Code: W35z*

Wall Hung Tablet



All Britton WC fittings are factory set at 3L and 6L flush. They can be adjusted on site to flush at 2½L and 4½L.



As shown: Tablet wall hung ocean W35O
(see page 40 for Curve wall hung pan & soft close seat).

Colours

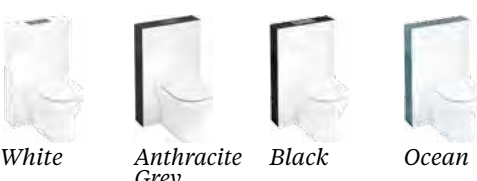

* To order the correct furniture colour simply remove the 'z' from the product code and replace it with 'W' for White, 'B' for Black, 'G' for Anthracite Grey or 'O' for Ocean.



Wall hung tablet
with 3 / 6 litre cistern & dual flush plate
W: 55cm, D: 15cm, H 90cm
Code: W35z*
and steel frame for wall hung WC unit
Code: W33A

Bathing

Britton offers an extensive collection of free-standing, single or double-ended, off-set and showering baths from the Cleargreen range. Each of the baths are manufactured to produce a greener product using 30% recycled material, built stronger to withstand an enormous weight of 2.3 tonnes. The baths manufactured in this way also retain heat for 30 minutes longer than a standard bath providing you with a longer, more relaxing bathe. The combination of the unique manufacturing process and steel re-inforcing rods within the bath rims, make Cleargreen baths the most rigid on the market.

For full technical details go to www.brittonbathrooms.com

Looking for a stronger bath?

- > Built stronger to withstand 2.3 tonnes
- > Retains heat 30 minutes longer than a standard bath
- > 10 year guarantee
- > Supplied with galvanised steel leg frame
- > Manufactured from 30% recycled material

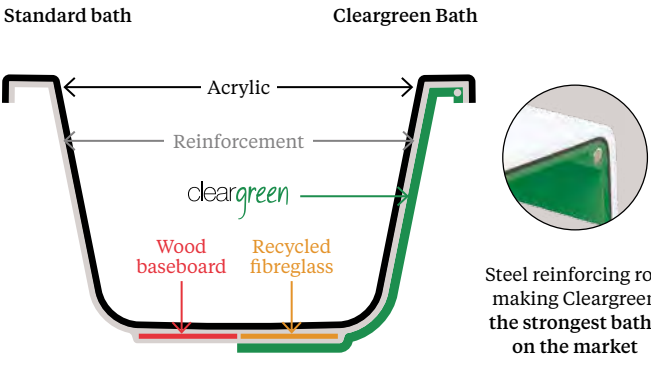

FREEFUERTE A sumptuous, oval shaped free-standing two piece bath with surround which will act as an eye-catching centre-piece to any contemporary bathroom. Pair with a luxurious floor-standing bath filler.



Freefuerte bath (174cm x 87cm) and surround and Sapphire floor-standing bath filler. Click-clack bath waste and overflow.
See page 108 for technical details on the Freefuerte bath.

FREESTARK A subtle free-standing two piece bath with soft lines and rounded edges. Match with the Fine ceramic range for seamless consistent design across your contemporary bathroom.



Freestark bath (174cm x 80cm) and surround with Crystal deck-mounted bath filler. Click-clack bath waste and overflow.
See page 108 for technical details on the Freestark bath.



10 YEAR GUARANTEE
ON ALL OUR BATHS
See website for details
www.brittonbathrooms/home/guarantee



Freefuerte



Freestark



FREEFORTIS A slanted ergonomically shaped two piece bath, which looks great paired with the Cube ceramic range. For an ultra minimalistic look, opt with a single lever bath filler.

Freefortis bath (180cm x 80cm) and surround with Crystal single lever bath filler on single stand pipe. Click-clack bath waste and overflow.

See page 109 for technical details on the Freefortis bath.



10 YEAR GUARANTEE
ON ALL OUR BATHS
See website for details
www.brittonbathrooms/home/guarantee



SATURN This unique back-to-wall bath will make the most of available wall space within your bathroom, giving a greater impression of space. Its smooth curves look great in contemporary settings and the corner edges of the bath provide ample space for bathroom necessities.

Opposite page: Saturn bath (169cm x 75cm) and surround, Crystal bath shower mixer and click clack waste.

See page 111 for technical details on the Saturn bath.



Saturn



10 YEAR GUARANTEE
ON ALL OUR BATHS
See website for details
www.brittonbathrooms/home/guarantee



NOUVEAU & NOUVEAU PETITE The elliptical shape with its substantial edge makes the Nouveau a striking centrepiece in any contemporary bathroom. Its grand structure with a length of 178cm, allows for generous internal capacity. The same striking bath is available with a smaller length of 150cm to fit into most contemporary bathrooms.

Opposite page and above: Nouveau bath and surround and Crystal bath shower mixer.
See page 107 for technical details on the Nouveau baths.



Nouveau (178cm x 81cm)



Nouveau Petite (150cm x 80cm)

Free-standing baths

NOUVEAU



Nouveau modern bath, page 106

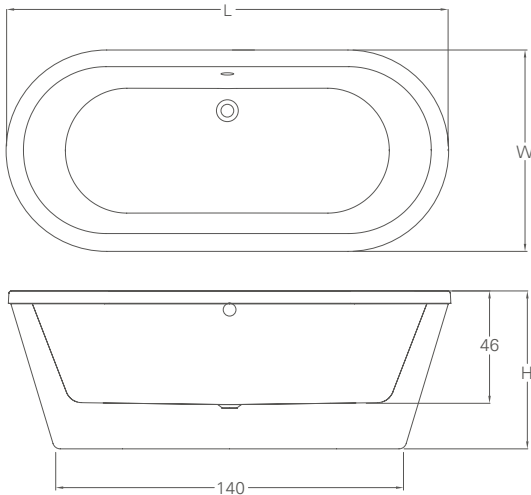

Nouveau modern bath

| | |
|-----------------------|-------------------------------|
| Bath | M1N |
| Surround | M1B |
| Complete bath | |
| Size | L: 178, W: 81, H: 60 |
| Weight empty | 36 kg |
| Material | TSFR |
| Tap hole option | 0, 1, 2 (supplied un-drilled) |
| Compatible bath grips | R30, R37 |
| Compatible wastes | CW8, see p109 |
| Compatible overflow | Hole pre-drilled |

NOUVEAU PETITE



Nouveau Petite modern bath, page 106

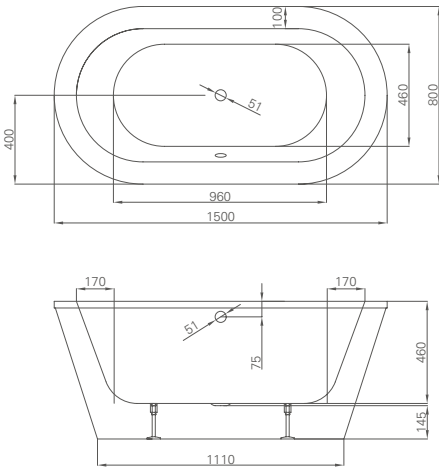

Nouveau Petite modern bath

| | |
|-----------------------|-------------------------------|
| Bath | M2N |
| Surround | M2B |
| Complete bath | |
| Size | L: 150, W: 80, H: 63 |
| Weight empty | 26 kg |
| Material | TSFR |
| Tap hole option | 0, 1, 2 (supplied un-drilled) |
| Compatible bath grips | R30, R37 |
| Compatible wastes | CW8, see p109 |
| Compatible overflow | Hole pre-drilled |

Free-standing baths



10 YEAR GUARANTEE
ON ALL OUR BATHS
See website for details
www.brittonbathrooms/home/guarantee

FREEFUERTE



Freefuerte double-ended free-standing bath, *page 102*

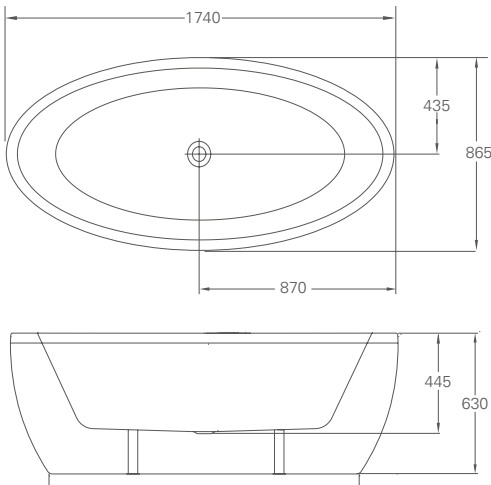

| | |
|---|-------------------------------|
| Freefuerte double-ended free-standing bath & surround | |
| Bath | R31 |
| Surround | R32 |
| Complete bath | |
| Size | L: 174, W: 87, H: 63 |
| Weight empty | 45 kg |
| Material | TSFR |
| Tap hole option | 0, 1, 2 (supplied un-drilled) |
| Compatible bath grips | R30, R37 |
| Compatible wastes | CW8 |
| Compatible overflow | Hole pre-drilled |

FREESTARK



Freestark double-ended free-standing bath, *page 103*

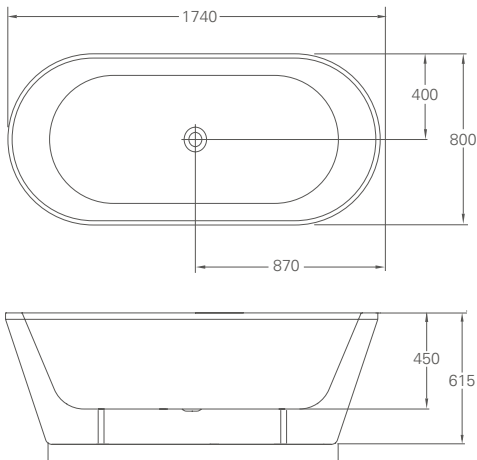

| | |
|--|-------------------------------|
| Freestark double-ended free-standing bath & surround | |
| Bath | R33 |
| Surround | R34 |
| Complete bath | |
| Size | L: 174, W: 80, H: 62 |
| Weight empty | 44 kg |
| Material | TSFR |
| Tap hole option | 0, 1, 2 (supplied un-drilled) |
| Compatible bath grips | R30, R37 |
| Compatible wastes | CW8 |
| Compatible overflow | Hole pre-drilled |



10 YEAR GUARANTEE
ON ALL OUR BATHS
See website for details
www.brittonbathrooms/home/guarantee

FREEFORTIS



Freefortis double-ended free-standing bath, *page 104*

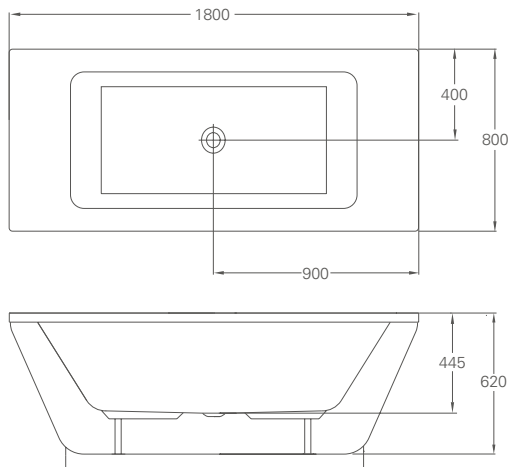

| | |
|---|-------------------------------|
| Freefortis double-ended free-standing bath & surround | |
| Bath | R35 |
| Surround | R36 |
| Complete bath | |
| Size | L: 180, W: 80, H: 62 |
| Weight empty | 54 kg |
| Material | TSFR |
| Tap hole option | 0, 1, 2 (supplied un-drilled) |
| Compatible bath grips | R30, R37 |
| Compatible wastes | CW8 |
| Compatible overflow | Hole pre-drilled |

Bath Grips



Luxury bath grips (pair)
For use on all rectangular baths
D: 3, W: 27, H: 7
Weight: 1.9kg
Finish: Chrome
Code: R30



Standard bath grips (pair)
For use on all rectangular baths
D: 2, W: 22, H: 4
Weight: 0.4kg
Finish: Chrome
Code: R37

Waste



Click-clack bath waste
For single and double ended baths
D: 94, W: 85, H: 800
Code: CW8



SATURN



Saturn modern bath, page 105

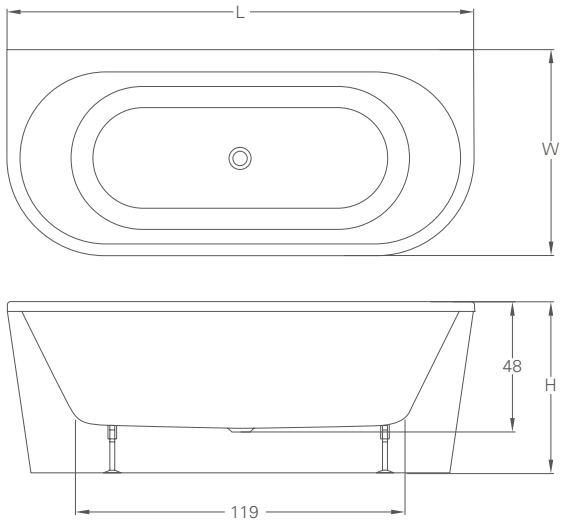

| | |
|--------------------------------|-------------------------------|
| New Nouveau Petite modern bath | |
| Bath | M2N |
| Surround | M2B |
| Complete bath | |
| Size | L: 150, W: 80, H: 63 |
| Weight empty | 26 kg |
| Material | TSFR |
| Tap hole option | 0, 1, 2 (supplied un-drilled) |
| Compatible bath grips | R30, R37 |
| Compatible wastes | CW8, see p109 |
| Compatible overflow | Hole pre-drilled |

Why Cleargreen baths are the best

- Built stronger to withstand 2.3 tonnes!
- Retains heat longer than a standard bath
- 10 year guarantee on all Cleargreen baths
- Supplied with galvanised steel leg frame
- Manufactured from 30% recycled material
- Cleargreen baths use encapsulated recycled composite baseboards which is stronger and greener than chipboard
- Cleargreen baths use reinforced quality Lucite acrylic
- 10mm diameter steel reinforcing rod runs inside rectangular bath rims

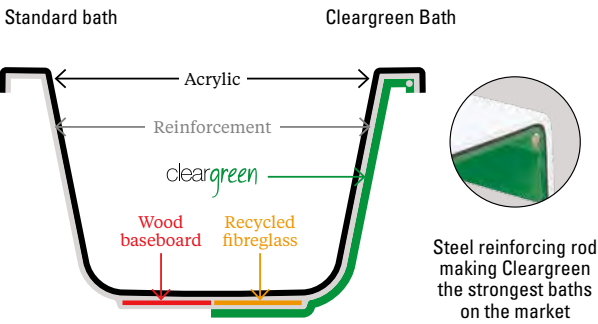



SUSTAIN SINGLE ENDED BATH - SQUARE

The Sustain provides a square internal shape for those preferring the more geometric and angular look. With the taps situated at one end of the bath, this is a great option to place into corners or against a wall.

Optional bath grips (pair)



Above: Sustain bath 170cm x 70cm with Crystal bath filler, Click-clack bath waste and overflow.

See page 118 for technical details on the Sustain bath.
To view shower screens that fit the Sustain see page 128-129.



Length

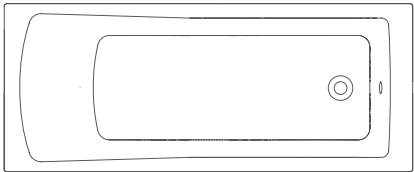

Width

Available in

| | Length | Width |
|-----|--------|-------|
| R4 | 160cm | 70cm |
| R5 | 170cm | 70cm |
| R6 | 170cm | 75cm |
| R42 | 170cm | 80cm |
| R7 | 180cm | 80cm |

REUSE SINGLE ENDED BATH - ROUND

The Reuse bath has a rounded, softer internal shape for those who prefer a simple look with clean lines.

Opposite page: Reuse bath 170 x 70cm, four-fold bath screen and Crystal bath shower mixer.
Click-clack bath waste and overflow.

See page 118 for technical details on the Reuse bath, to view shower screens that fit the Reuse see page 120-121.



10 YEAR GUARANTEE
ON ALL OUR BATHS

See website for details
www.brittonbathrooms/home/guarantee



Length

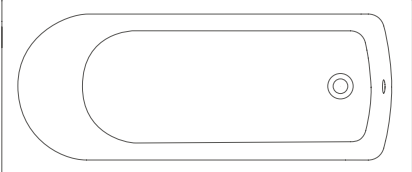

Width

Available in

| | Length | Width |
|-----|--------|-------|
| R11 | 150cm | 70cm |
| R51 | 150cm | 75cm |
| R12 | 160cm | 70cm |
| R13 | 170cm | 70cm |
| R52 | 170cm | 75cm |
| R44 | 170cm | 80cm |
| R14 | 180cm | 75cm |

A double-ended bath gives a great amount of flexibility. Place your bath against a wall or into a corner and select the front and end panels you require. Alternatively, set your bath into a boxed unit, which creates a floating appearance and gives you the ability to seamlessly set your bath into its surroundings. The major benefit is that the taps are fitted in the centre of the bath, allowing you to sit at either end of the bath without them in the way.



10 YEAR GUARANTEE
ON ALL OUR BATHS
See website for details
www.brittonbathrooms/home/guarantee



ENVIRO DOUBLE ENDED BATH - SQUARE

The Enviro provides a square internal shape for those preferring the more angular look.

Opposite page and above: Enviro bath 170 x 70cm with front panel and end panels each with Sapphire deck mounted bath shower mixer. Click-clack bath waste and overflow.

See page 119 for technical details on the Enviro bath, to view shower screens that fit the Enviro see page 120-121.



Length

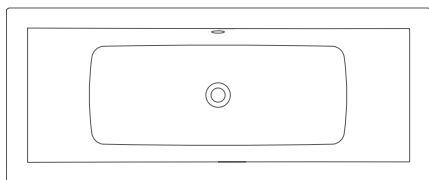

Width

Available in

| Length | Width |
|--------|-------|
| 170cm | 70cm |
| 170cm | 75cm |
| 170cm | 80cm |
| 180cm | 80cm |



VERDE DOUBLE ENDED BATH - ROUND
The Verde bath has a rounded, softer internal shape.



Length

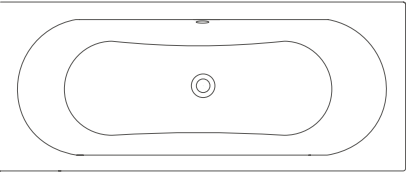

Width

Opposite page: Verde bath 170 x 70cm with front panel and end panels each with Sapphire deck mounted bath filler. Click-clack bath waste and overflow.
See page 119 for technical details on the Verde bath, to view shower screens that fit the Verde see page 120-121.

Available in

| Length | Width |
|--------|-------|
| 160cm | 75cm |
| 170cm | 70cm |
| 170cm | 75cm |
| 170cm | 80cm |
| 180cm | 75cm |
| 180cm | 80cm |
| 180cm | 90cm |
| 190cm | 80cm |



VIRIDE OFFSET BATH This offset bath is available in either right or left-handed options to give you the flexibility of placement within your bathroom. The soft curves gives this bath a contemporary feel and allows the piece to blend harmoniously into its surroundings.



Left-hand



Right-hand



10 YEAR GUARANTEE ON ALL OUR BATHS
See website for details
www.brittonbathrooms/home/guarantee

Above: Viride bath left-handed with offset panel with Crystal deck-mounted bath shower mixer. Cube 60cm basin with square fronted full pedestal with Crystal basin mixer. Click-clack bath waste and overflow.
See page 120 for technical details on the Viride bath, to view shower screens that fit the Viride see page 120-121.



Length

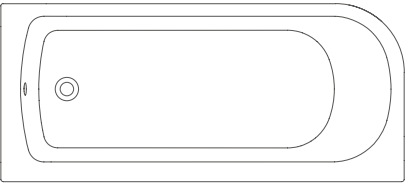

Width

Available in

| | Length | Width | Handed |
|-----|--------|-------|--------|
| R38 | 170cm | 75cm | Left |
| R39 | 170cm | 75cm | Right |
| R53 | 180cm | 75cm | Left |
| R54 | 180cm | 75cm | Right |

Single-ended baths

- Why Cleargreen baths are the best
- Built stronger to withstand 2.3 tonnes!
 - Retains heat longer than a standard bath
 - 10 year guarantee on all Cleargreen baths
 - Supplied with galvanised steel leg frame
 - Manufactured from 30% recycled material
- Cleargreen baths use encapsulated recycled composite baseboards which is stronger and greener than chipboard
 - Cleargreen baths use reinforced quality Lucite acrylic
 - 10mm diameter steel reinforcing rod runs inside rectangular bath rims

SUSTAIN

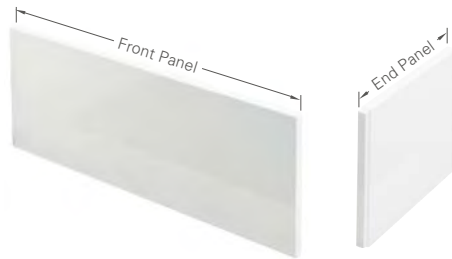

Sustain bath, page 112

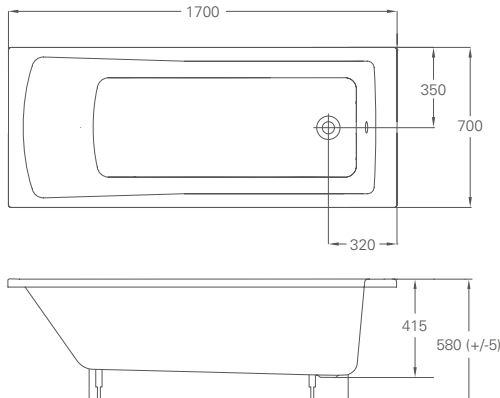

Sustain Baths & Panels
Single-ended - Square internal

| Length (L) | Width (W) | Bath Code | Front Panel Code | End Panel Code |
|------------|-----------|-----------|------------------|----------------|
| 160 | 70 | R4 | R24F | R27E |
| 170 | 70 | R5 | R25F | R27E |
| 170 | 75 | R6 | R25F | R28E |
| 170 | 80 | R42 | R25F | R29E |
| 180 | 80 | R7 | R26F | R29E |

Compatible wastes CW8
Compatible shower screens BS1, BS2, BS3, BS4, BS5
Compatible bath grips R37, R30
Overflow pre-drilled
Acrylic panels are fully reinforced with GRP

REUSE

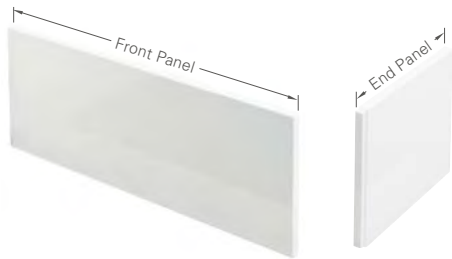

Reuse bath, page 113

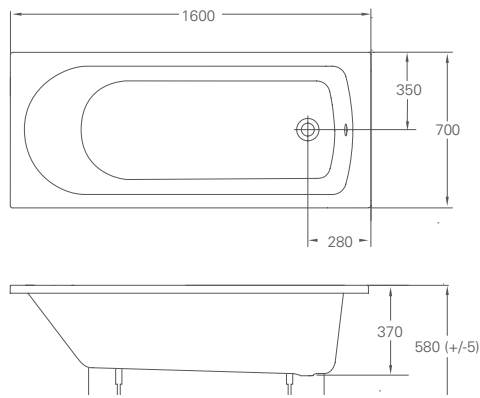

Reuse Baths & Panels
Single ended - Rounded internal

| Length (L) | Width (W) | Bath Code | Front Panel Code | End Panel Code |
|------------|-----------|-----------|------------------|----------------|
| 150 | 70 | R11 | R23F | R27E |
| 150 | 75 | R51 | R23F | R28E |
| 160 | 70 | R12 | R24F | R27E |
| 170 | 70 | R13 | R25F | R27E |
| 170 | 75 | R52 | R25F | R27E |
| 170 | 80 | R44 | R25F | R29E |
| 180 | 75 | R14 | R26F | R28E |

Compatible wastes CW8
Compatible shower screens BS1, BS2, BS3, BS4, BS5
Compatible bath grips R37, R30
Overflow pre-drilled
Acrylic panels are fully reinforced with GRP

Double-ended baths

ENVIRO

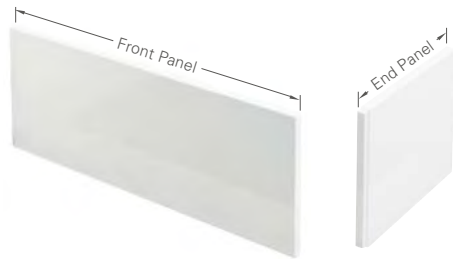

Enviro bath, page 115

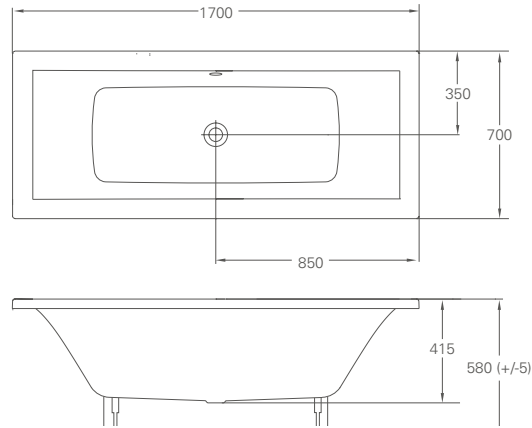

Enviro Baths & Panels
Double ended - Square internal

| Length (L) | Width (W) | Bath Code | Front Panel Code | End Panel Code |
|------------|-----------|-----------|------------------|----------------|
| 170 | 70 | R1 | R25F | R27E |
| 170 | 75 | R2 | R25F | R28E |
| 170 | 80 | R41 | R25F | R29E |
| 180 | 80 | R3 | R26F | R29E |

Compatible wastes CW8
Compatible shower screens BS1, BS2, BS3, BS4, BS5
Compatible bath grips R37, R30
Overflow pre-drilled
Acrylic panels are fully reinforced with GRP

VERDE

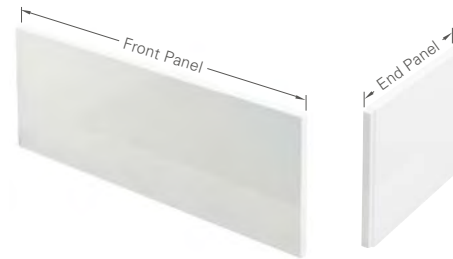

Verde bath, page 116

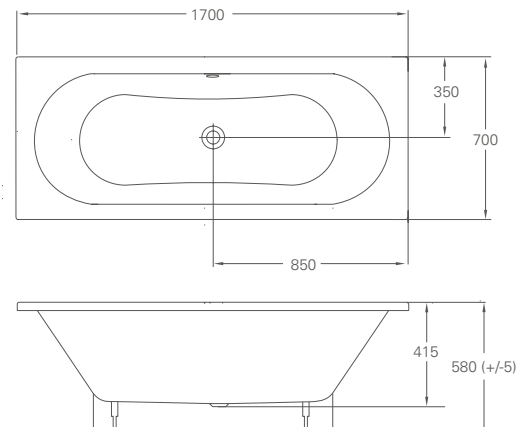

Verde Baths & Panels
Double ended - Rounded internal

| Length (L) | Width (W) | Bath Code | Front Panel Code | End Panel Code |
|------------|-----------|-----------|------------------|----------------|
| 160 | 75 | R45 | R24F | R28E |
| 170 | 70 | R8 | R25F | R27E |
| 170 | 75 | R9 | R25F | R27E |
| 170 | 80 | R43 | R25F | R29E |
| 180 | 75 | R46 | R26F | R28E |
| 180 | 80 | R10 | R26F | R29E |
| 180 | 90 | R47 | R26F | R49E |
| 190 | 80 | R48 | R50F | R29E |

Compatible wastes CW8
Compatible shower screens BS1, BS2, BS3, BS4, BS5
Compatible bath grips R37, R30
Overflow pre-drilled
Acrylic panels are fully reinforced with GRP

- Why Cleargreen baths are the best
- Built stronger to withstand 2.3 tonnes!
 - Retains heat longer than a standard bath
 - 10 year guarantee on all Cleargreen baths
 - Supplied with galvanised steel leg frame
 - Manufactured from 30% recycled material
- Cleargreen baths use encapsulated recycled composite baseboards which is stronger and greener than chipboard
 - Cleargreen baths use reinforced quality Lucite acrylic
 - 10mm diameter steel reinforcing rod runs inside rectangular bath rims

Shower screens

VIRIDE

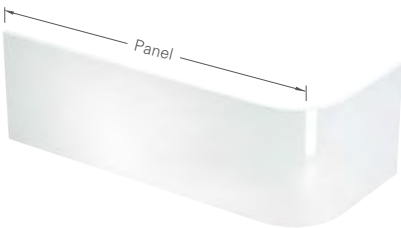

Viride offset bath, page 117

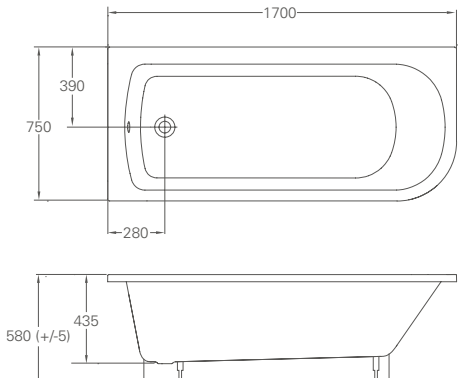

Viride Baths & Panels

| Off-set | | Left Hand Baths | | Right Hand Baths | |
|------------|-----------|-----------------|------------|------------------|------------|
| | | | | | |
| Length (L) | Width (W) | Bath Code | Panel Code | Bath Code | Panel Code |
| 170 | 75 | R38 LH | R40 | R39 RH | R40 |
| 180 | 75 | R53 LH | R55 | R54 RH | R55 |

Compatible wastes CW8
Compatible shower screens BS1, BS2, BS3, BS4, BS5
Compatible bath grips R37, R30
Overflow pre-drilled
Acrylic panels are fully reinforced with GRP

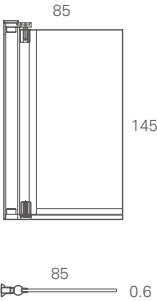

Single panel bathscreen
3M coating as standard
(Can be fitted to either left or right hand baths)
D: 2, W: 85, H: 145
Screen thickness: 6mm
Code: BS1

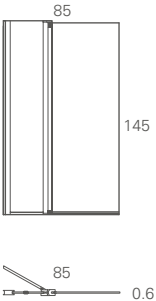

Bathscreen with fixed panel
3M coating as standard
(Can be fitted to either left or right hand baths)
D: 2, W: 85, H: 145
Screen thickness: 6mm
Code: BS2



Bathscreen with access panel
3M coating as standard
(Can be fitted to either left or right hand baths)
D: 2, W: 85, H: 145
Screen thickness: 6mm
Code: BS3

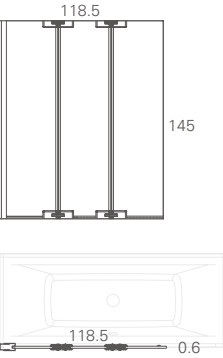

Three-panel bathscreen
3M coating as standard
(Can be fitted to either left or right hand baths)
D: 2, W: 118, H: 145
Screen thickness: 5mm
Code: BS4

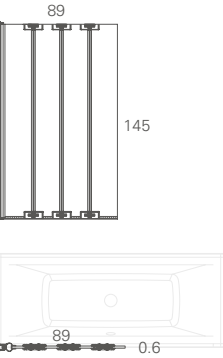

Four-panel bathscreen
3M coating as standard
(Can be fitted to either left or right hand baths)
D: 2, W: 88, H: 145
Screen thickness: 5mm
Code: BS5



ECOCURVE The EcoCurve showering bath features sweeping lines and elegant curves, which provide a generous showering space. Available in both left or right-handed options, pair with a specific EcoCurve shower screen for the flexibility of both a shower and a relaxing bathe.

For the full range of Britton thermostatic shower valves see page 129.



Right-hand



Left-hand



**10 YEAR GUARANTEE
ON ALL OUR BATHS**
See website for details
www.brittonbathrooms/home/guarantee

Above: Concealed single outlet thermostatic shower valve including round shower arm and rose.

See page 126 for technical details on the EcoCurve bath, to view shower screens that fit the EcoCurve see page 126.



ECOSQUARE A geometric and angular showering bath to pair with other square or Cube shaped products from the Britton range. The EcoSquare is available in both left and right-handed options to make placement flexible within your bathroom. Choose an EcoSquare bath screen with access panel which allows you to reach in and turn on your shower without getting wet. It also features a unique pivoting glass panel to either follow the edge of the bath preventing flooding, or move into the bath to create more of an enclosure feel.



Right-hand



Left-hand



**10 YEAR GUARANTEE
ON ALL OUR BATHS**
See website for details
www.brittonbathrooms/home/guarantee

Above: EcoSquare right handed showering bath 170 x 85cm, EcoSquare front panel, EcoSquare end panel, EcoSquare bathscreen and Sapphire bath shower mixer. Click-clack bath waste and overflow.

See page 128 for technical details on the EcoCurve bath, to view shower screens that fit the EcoCurve see page 128.



ECOROUND A subtle rounded showering bath, which will work seamlessly with Curve or Compact ceramic ranges. The EcoRound comes in both a 170cm length and a 150cm for bathrooms where space is limited but its subtle curves provide an exceptionally generous showering space. Mount taps to the corner of the bath, for a comfortable bathe.

Opposite page: EcoRound left handed showering bath 170 x 90cm. EcoRound front panel, EcoRound end panel, EcoRound bath screen, Crystal bath filler. Click-clack bath waste and overflow.

See page 127 for technical details on the EcoRound bath.



Right-hand



Left-hand



Showering baths

10
year
guarantee

10 YEAR GUARANTEE
ON ALL OUR BATHS
See website for details
www.brittonbathrooms/home/guarantee

ECOCURVE



EcoCurve showering bath, page 122

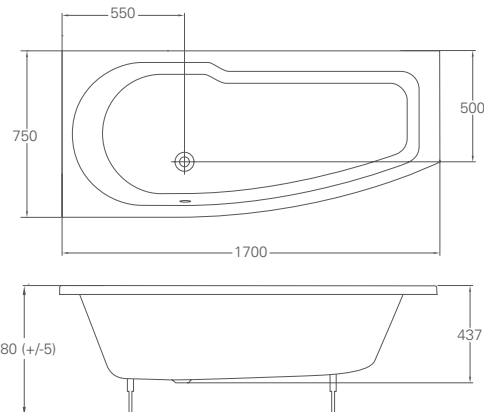

EcoCurve Baths & Panels

Showering

Left Hand Baths

| Length (L) | Width (W) | Bath Code | Front Panel Code | End Panel Code |
|------------|-----------|-----------|------------------|----------------|
| 170 | 75/50* | R15 LH | R16F | R16E |

Right Hand Baths

| Length (L) | Width (W) | Bath Code | Front Panel Code | End Panel Code |
|------------|-----------|-----------|------------------|----------------|
| 170 | 75/50* | R16 RH | R16F | R16E |

*75cm at the widest, 50cm at the narrowest point.

- Compatible wastes
- CW8
- Compatible shower screens
- EcoCurve bath screen on this page
- Compatible bath grips
- R37, R30 (placement should be away from the screen)
- Overflow pre-drilled
- Acrylic panels are fully reinforced with GRP

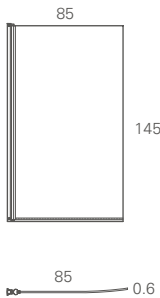

EcoCurve bathscreen

3M coating as standard
(Can be fitted to either left or right hand baths)
D: 2, W: 85, H: 145
Screen thickness: 6mm
Code: BS6

ECOROUND



EcoRound showering bath, page 124

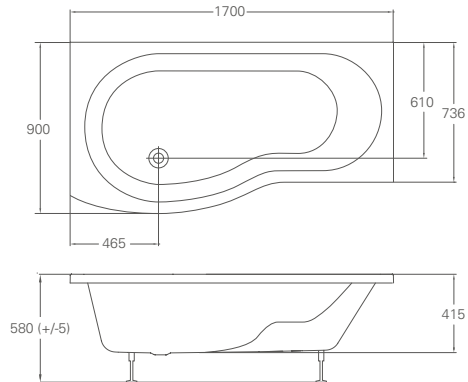

EcoRound Baths & Panels

Showering

Left Hand Baths

| Length (L) | Width (W) | Bath Code | Front Panel Code | End Panel Code |
|------------|-----------|-----------|------------------|----------------|
| 150 | 81/74* | R19 LH | R20F | R20E |
| 170 | 90/74* | R21 LH | R22F | R20E |

Right Hand Baths

| Length (L) | Width (W) | Bath Code | Front Panel Code | End Panel Code |
|------------|-----------|-----------|------------------|----------------|
| 150 | 81/74* | R20 RH | R20F | R20E |
| 170 | 90/74* | R22 RH | R22F | R20E |

*90cm at the widest, 74cm at the narrowest point.

- Compatible wastes
- CW8
- Compatible shower screens
- EcoCurve bath screen on this page
- Compatible bath grips
- R37, R30 (placement should be away from the screen)
- Overflow pre-drilled
- Acrylic panels are fully reinforced with GRP

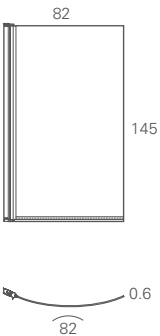

EcoRound bathscreen

3M coating as standard
(Can be fitted to either left or right hand baths)
D: 2, W: 82, H: 145
Screen thickness: 6mm
Code: BS7

Showering baths



10 YEAR GUARANTEE
ON ALL OUR BATHS
See website for details
www.brittonbathrooms/home/guarantee

ECOSQUARE



EcoSquare showering bath, page 123

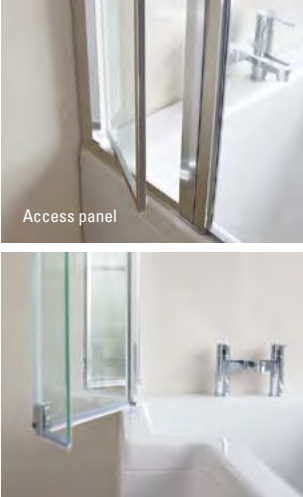
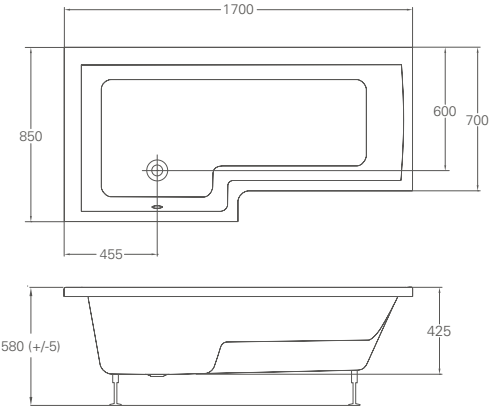

with access panel

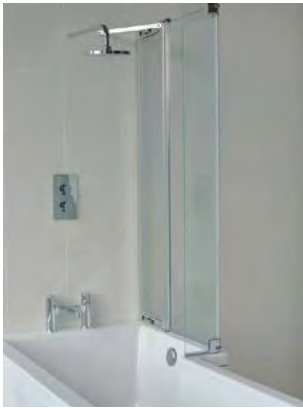
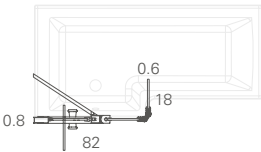
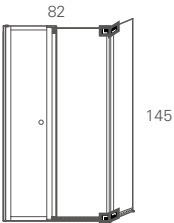

EcoSquare Baths & Panels
Showering

Left Hand Baths

| Length (L) | Width (W) | Bath Code | Front Panel Code | End Panel Code |
|---------------|--------------|--------------|------------------------|----------------------|
| 170 | 85/70* | R17 LH | R18F | R27E |

Right Hand Baths

| Length (L) | Width (W) | Bath Code | Front Panel Code | End Panel Code |
|---------------|--------------|--------------|------------------------|----------------------|
| 170 | 85/70* | R18 RH | R18F | R27E |

*85cm at the widest, 70cm at the narrowest point.

Compatible wastes CW8
Compatible shower screens EcoSquare bath screen on this page
Compatible bath grips R37, R30 (placement should be away from the screen)
Overflow pre-drilled
Acrylic panels are fully reinforced with GRP

EcoSquare bathscreen
with access panel
3M coating as standard
Screen thickness: 6mm
D: 18, W: 82, H: 145
Code: BS8L (Left hand)
Code: BS8R (Right hand)

EcoSquare bathscreen
with fixed panel
3M coating as standard
Screen thickness: 6mm
D: 18, W: 82, H: 145

Thermostatic shower valves



Concealed thermostatic shower
valve with two controls
(2 outlets)*
Including round shower arm, rose &
slide bar kit
Valve (V51)
Arm, rose & kit (V53)



Concealed thermostatic shower
valve with three controls
(2 outlets)*
Including round shower arm, rose &
slide bar kit
Valve (V52)
Arm, rose & kit (V53)



Concealed thermostatic shower
valve with two controls
(2 outlets)*
Including square shower arm, rose &
slide bar kit
Valve (V51)
Arm, rose & kit (V54)



Concealed single outlet
thermostatic shower valve*
Including round shower arm & rose
Valve (V50)
Arm & rose (V57)



Concealed thermostatic shower
valve with three controls
(3 outlets)*
Including square shower arm, rose &
slide bar kit
Valve (V52)
Arm, rose & kit (V54)



Round exposed thermostatic
shower valve*
Including handset & hose
(V55)



Square exposed thermostatic
shower valve*
Including handset & hose
(V56)



Concealed single outlet
thermostatic shower valve*
Including square shower arm & rose
Valve (V50)
Arm & rose (V58)

*While stocks last.

Shower trays

The Zamori 35mm high shower tray range is the most extensive available, with over 60 models to choose from each to fit the space available in your bathroom. All trays are made in acrylic with the option of antibacterial agent, anti slip and slate effect. The trays are made from high quality materials and are acrylic capped with a 20mm x 20mm steel tube to ensure a lifetime of use. The underside is insulated with a flat ABS sheet, making installation and levelling very easy. The range of shapes covers square, rectangular, pentangle, quadrant and offset quadrant.



FLEXIBLE INSTALLATION

There are a number of ways you can install your shower tray.

Option 1
Placed flat on the floor

Option 2
Sunk into the floor

Option 3
Raised above the floor

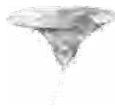

VORTEX TURBO WASTE

All our shower wastes are 90mm diameter high flow Vortex Turbo wastes designed to fit all our trays. They comply with EN274-3. This ensures that the water flows out at up to 30 litres per minute, making the Zamori shower waste one of the most efficient available - suitable for high volume showering applications.

The waste incorporates an easy clean removable filter and is supplied with a solvent weld adaptor for different waste pipe sizes.



ANTI-BACTERIAL

Zamori has added the silver-based anti bacterial additive Zeomic into the manufacturing process. The anti microbial qualities protect against harmful bacteria and suppresses mould growth,



ANTI-SLIP

Zamori anti-slip is simply the finest available with the highest anti-slip rating. We are the only manufacturer to thermo bond the Swiss Grip Antislip onto the tray with a curing process - to ensure better performance for a cleaner & longer lasting surface.



DIN51097 class C anti-slip ramp test

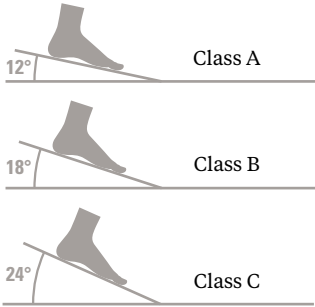

PATENTED REINFORCEMENT

All our trays are acrylic framed with our patented steel frame, formed to be the exact shape of the tray, to ensure rigidity for a lifetime of use. The trays are flat on the under-surface; this makes installation and levelling very easy.

Our steel frame is the subject of Patent Number: GB2440719 (A)

- 1 Acrylic capped ABS layer
- 2 Bonding layer
- 3 Thickness control pad
- 4 Steel frame structure
- 5 PU Foam
- 6 Insulation layer - ABS sheet

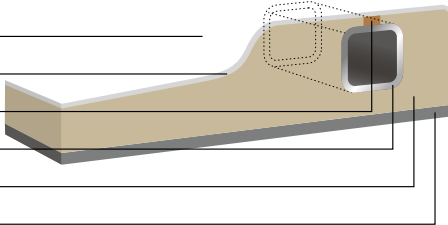



Anti slip



10 year guarantee*



Flexible installation

Square



Square shower trays

| Length | Width | Anti-bacterial | Anti-bacterial & anti-slip | Anti-bacterial & slate effect | Panel Pack |
|--------|-------|----------------|----------------------------|-------------------------------|------------|
| 70 | 70 | Z1158 | Z1158A | Z1158G | H |
| 76 | 76 | Z1159 | Z1159A | Z1159G | H |
| 80 | 80 | Z1160 | Z1160A | Z1160G | H |
| 90 | 90 | Z1161 | Z1161A | Z1161G | H |
| 100 | 100 | Z1162 | Z1162A | Z1162G | I |

Exclude wastes.

Walk-In



Walk-In shower trays

| Length | Width | Anti-bacterial | Anti-bacterial & anti-slip | Anti-bacterial & slate effect | Panel Pack |
|--------|-------|----------------|----------------------------|-------------------------------|------------|
| 140 | 90 | Z1186 | Z1186A | Z1186G | B |
| 160 | 80 | Z1187 | Z1187A | Z1187G | B |
| 170 | 80 | Z1188 | Z1188A | Z1188G | B |

Exclude wastes.



Patented reinforcement



Anti bacterial

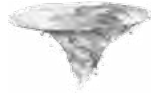

Vortex wastes

Offset Quadrant



Left handed trays



Right handed trays

Offset Quadrant shower trays

| Length | Width | Handed | Anti-bacterial | Anti-bacterial & anti-slip | Anti-bacterial & slate effect | Panel Pack |
|--------|-------|--------|----------------|----------------------------|-------------------------------|------------|
| 90 | 76 | Left | Z1195 | Z1195A | Z1195G | J |
| 90 | 76 | Right | Z1196 | Z1196A | Z1196G | J |
| 90 | 80 | Left | Z1197 | Z1197A | Z1197G | J |
| 90 | 80 | Right | Z1198 | Z1198A | Z1198G | J |
| 100 | 80 | Left | Z1199 | Z1199A | Z1199G | E |
| 100 | 80 | Right | Z1200 | Z1200A | Z1200G | E |
| 120 | 80 | Left | Z1201 | Z1201A | Z1201G | E |
| 120 | 80 | Right | Z1202 | Z1202A | Z1202G | E |
| 120 | 90 | Left | Z1203 | Z1203A | Z1203G | E |
| 120 | 90 | Right | Z1204 | Z1204A | Z1204G | E |

Exclude wastes.

Quadrant



Quadrant shower trays

| Length | Width | Anti-bacterial | Anti-bacterial & anti-slip | Anti-bacterial & slate effect | Panel Pack |
|--------|-------|----------------|----------------------------|-------------------------------|------------|
| 80 | 80 | Z1192 | Z1192A | Z1192G | D |
| 90 | 90 | Z1193 | Z1193A | Z1193G | D |
| 100 | 100 | Z1194 | Z1194A | Z1194G | G |

Exclude wastes.



Anti slip



10 year guarantee*



Flexible installation

Rectangle



Rectangle shower trays (with corner waste)

| Length | Width | Anti-bacterial | Anti-bacterial & anti-slip | Anti-bacterial & slate effect | Panel Pack |
|--------|-------|----------------|----------------------------|-------------------------------|------------|
| 90 | 76 | Z1163 | Z1163A | Z1163G | H |
| 90 | 80 | Z1164 | Z1164A | Z1164G | H |
| 100 | 70 | Z1165 | Z1165A | Z1165G | A |
| 100 | 76 | Z1166 | Z1166A | Z1166G | A |
| 100 | 80 | Z1167 | Z1167A | Z1167G | A |
| 100 | 90 | Z1168 | Z1168A | Z1168G | A |
| 110 | 70 | Z1169 | Z1169A | Z1169G | B |
| 110 | 76 | Z1170 | Z1170A | Z1170G | B |
| 110 | 80 | Z1171 | Z1171A | Z1171G | B |
| 110 | 90 | Z1172 | Z1172A | Z1172G | B |
| 120 | 70 | Z1173 | Z1173A | Z1173G | B |
| 120 | 76 | Z1174 | Z1174A | Z1174G | B |

Exclude wastes.



Rectangle shower trays (with off-centre waste)

| Length | Width | Anti-bacterial | Anti-bacterial & anti-slip | Anti-bacterial & slate effect | Panel Pack |
|--------|-------|----------------|----------------------------|-------------------------------|------------|
| 120 | 80 | Z1175 | Z1175A | Z1175G | B |
| 120 | 90 | Z1176 | Z1176A | Z1176G | B |
| 120 | 100 | Z1230 | Z1230A | Z1230G | B |
| 140 | 80 | Z1177 | Z1177A | Z1177G | B |
| 140 | 90 | Z1178 | Z1178A | Z1178G | B |

Exclude wastes.



Patented reinforcement



Anti bacterial



Vortex wastes

Large Rectangle



Large Rectangle shower trays (with off-centre waste)

| Length | Width | Anti-bacterial | Anti-bacterial & anti-slip | Anti-bacterial & slate effect | Panel Pack |
|--------|-------|----------------|----------------------------|-------------------------------|-------------------------|
| 150 | 70 | Z1179 | Z1179A | Z1179G | B |
| 150 | 76 | Z1180 | Z1180A | Z1180G | B |
| 150 | 80 | Z1181 | Z1181A | Z1181G | B |
| 150 | 90 | Z1361 | Z1361A | Z1361G | B |
| 160 | 70 | Z1182 | Z1182A | Z1182G | B |
| 160 | 80 | Z1231 | Z1231A | Z1231G | B |
| 160 | 90 | Z1232 | Z1232A | Z1232G | B |
| 170 | 70 | Z1183 | Z1183A | Z1183G | B |
| 170 | 76 | Z1184 | Z1184A | Z1184G | B |
| 170 | 80 | Z1185 | Z1185A | Z1185G | B |
| 170 | 90 | Z1341 | Z1341A | Z1341G | B |
| 170 | 100 | Z1342 | Z1342A | Z1342G | B |
| 180 | 80 | Z1343 | Z1343A | Z1343G | No panel pack available |
| 180 | 90 | Z1245 | Z1245A | Z1245G | No panel pack available |
| 180 | 100 | Z1344 | Z1344A | Z1344G | No panel pack available |

Exclude wastes.



Large Rectangle shower trays (with two wastes)

| Length | Width | Anti-bacterial | Anti-bacterial & anti-slip | Anti-bacterial & slate effect | Panel Pack |
|--------|-------|----------------|----------------------------|-------------------------------|-------------------------|
| 200 | 80 | Z1345 | Z1345A | Z1345G | No panel pack available |
| 200 | 90 | Z1346 | Z1346A | Z1346G | No panel pack available |
| 200 | 100 | Z1347 | Z1347A | Z1347G | No panel pack available |

Exclude wastes (require 2).



Anti slip



10 year guarantee*



Flexible installation

Pentangle



Pentangle shower trays

| Length | Width | Anti-bacterial | Anti-bacterial & anti-slip | Anti-bacterial & slate effect | Panel Pack |
|--------|-------|----------------|----------------------------|-------------------------------|------------|
| 90 | 90 | Z1191 | Z1191A | Z1191G | C |
| 100 | 100 | Z1246 | Z1246A | Z1246G | C |

Exclude wastes.

Offset Pentangle



Left handed trays



Right handed trays

Offset Pentangle shower trays

| Length | Width | Handed | Anti-bacterial | Anti-bacterial & anti-slip | Anti-bacterial & slate effect | Panel Pack |
|--------|-------|--------|----------------|----------------------------|-------------------------------|------------|
| 120 | 90 | Left | Z1403 | Z1403A | Z1403G | K |
| 120 | 90 | Right | Z1404 | Z1404A | Z1404G | K |
| 140 | 90 | Left | Z1401 | Z1401A | Z1401G | K |
| 140 | 90 | Right | Z1402 | Z1402A | Z1402G | K |

Exclude wastes.



Patented reinforcement



Anti bacterial



Vortex wastes

Wastes



High flow vortex shower waste
Chrome
D: 130, W: 115, H: 110
Z1205



High flow vortex shower waste
Slate effect
D: 130, W: 115, H: 110
Z1205G

Panel Packs



Shower tray panel packs
Includes acrylic fascia panel and legs. Choose your panel pack, see trays for reference.

| | Acrylic | Slate |
|---|----------|-----------|
| A | ZP1.ZL1 | ZP1G.ZL1 |
| B | ZP2.ZL2 | ZP2G.ZL2 |
| C | ZP3.ZL4 | ZP3G.ZL4 |
| D | ZP4.ZL4 | ZP4G.ZL4 |
| E | ZP5.ZL3 | ZP5G.ZL3 |
| G | ZP4.ZL5 | ZP4G.ZL5 |
| H | ZP1.ZL4 | ZP1G.ZL4 |
| I | ZP1.ZL2 | ZP1G.ZL2 |
| J | ZP5.ZL4 | ZP5G.ZL4 |
| K | ZP12.ZL1 | ZP12G.ZL1 |

Sealing Strips



Waterproof sealing strip
Our unique - 'easyseal' water sealing strip - takes minutes to install. All trays should be installed with a sealing mechanism - to prevent water seeping between the tray and the wall. This is especially true in bathrooms with wooden floors - where floor movement is far more likely. Supplied in a generous 4.1 metre length – the strip is cut to size when sealing the shower tray.
D: 100, W: 100, H: 30
Code: Z1208

bathroombrands.com

The Bathroom Brands Group
Lake View House,
Rennie Drive,
Dartford,
Kent
DA1 5FU

brittonbathrooms.com
info@bathroombrands.com
Tel +44(0)1322 473222

Join us on social:
facebook.com/brittonbathrooms
twitter.com/brittonbathrooms
pinterest.com/brittonbaths



Due to continuous improvements we reserve the right to change the product specification without prior notice. The text, images and layout of this catalogue are protected by copyright and other intellectual property rights. All images within this brochure are, where possible, a true representation of our products. Some colours may vary. Please visit the website for more information.

Our website should be used as reference for the most up to date product specification.

